

Benham & Reeves

**Woolwich High Street, Woolwich, SE18**

£416 per week, £1,803 per month + fees

 1 Bedroom    1 Bathroom    Furnished

A spacious, 3rd floor furnished apartment situated in a well-maintained portered complex, ideally located moments the Woolwich DLR train station and upcoming Woolwich Cross Rail. EPC B

Please [click here](#) for full detail

## Property features

**Spacious Contemporary furnished 1 bed 1 bath | Private balcony (80 SqFt additionally) | Fully Fitted Kitchen Integrated with Well Known Appliances | Internal Area: 565 SqFt | Utility Room | EPC-B | Air Ventilation | Double Glazed Windows | Resident Gymnasium and Concierge Service | Minutes to Woolwich DLR, Train and Cross Rail**

For more information about this property,  
please call our Woolwich branch on

**020 8051 0700**



Redress & Client Money Protection :

Benham and Reeves are members of The Property Ombudsman redress scheme and have Client Money protection with ARLA Propertymark. You can find more information on our website at <https://www.benhams.com/membership/>

Benham & Reeves

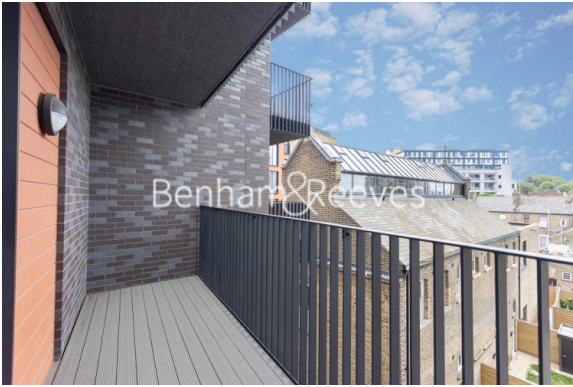

# Woolwich High Street, Woolwich, SE18

£416 per week, £1,803 per month + fees

www.benhams.com

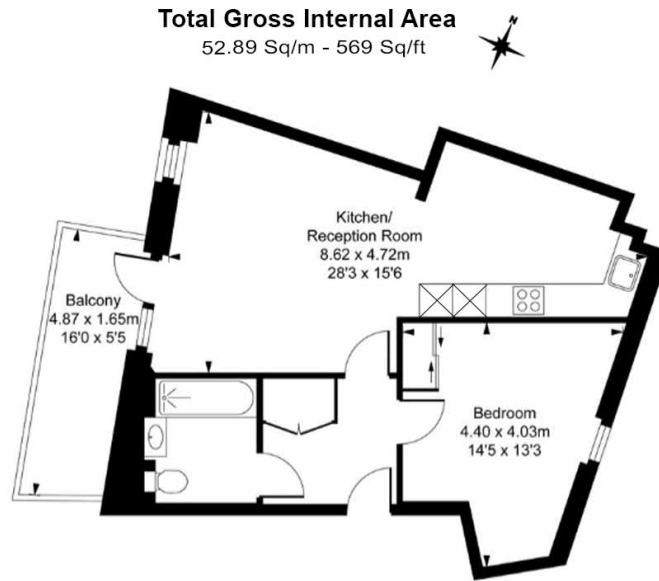

Floor Plan measurements are approximate and are for illustrative purposes only. While we do not doubt the floor plans accuracy, we make no guarantee, warranty or representation as to the accuracy and completeness of the floor plan.

Score	Energy rating	Current	Potential
92+	A		
81-91	B	85   B	85   B
69-80	C		
55-68	D		
39-54	E		
21-38	F		
1-20	G		

## London branches open six days a week Mon - Sat

Canary Wharf | City | Colindale | Dartmouth Park | Ealing | Fulham  
Hammersmith | Hampstead | Highgate | Hyde Park | Kensington | Kew  
Knightsbridge | Nine Elms | Shoreditch | Southall | Surrey Quays  
Wapping | Wembley | White City | Woolwich

## International offices

China | Hong Kong SAR | India | Indonesia | Qatar | Malaysia | Middle East | Pakistan  
Singapore | South Africa | Thailand | Turkey

