



Benham & Reeves

**Royal Victoria Gardens, Whiting Way, SE16**

£565 per week, £2,448 per month + fees

 2 Bedrooms    2 Bathrooms    Furnished

A well-presented apartment situated within a sought-after riverside development with residents' gym. The property is ideally located close to Surrey Quays Overground and Canada Water underground stations.

Please [click here](#) for full detail

## Property features

**Two Double Bedrooms | Onsite Tesco, Co-op, Popular Australian Restaurant | Fitted Kitchen | Local Restaurants, Cafes and Bars Nearby | Lift Access | EPC-B | 24-hour concierge | Two Bathrooms | Furnished with Private Balcony | Surrey Quays Station for Access into Shoreditch and City**

For more information about this property, please call our Surrey Quays branch on

**020 7740 3050**

Redress & Client Money Protection :

Benham and Reeves are members of The Property Ombudsman redress scheme and have Client Money protection with ARLA Propertymark. You can find more information on our website at <https://www.benhams.com/membership/>



Benham & Reeves

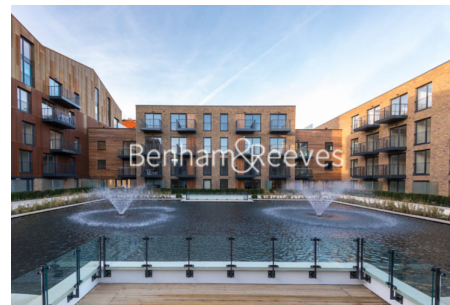
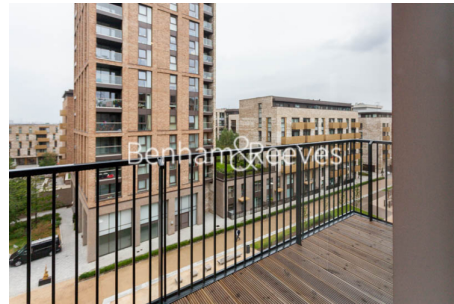



# Royal Victoria Gardens, Whiting Way, SE16

£565 per week, £2,448 per month + fees

www.benhams.com

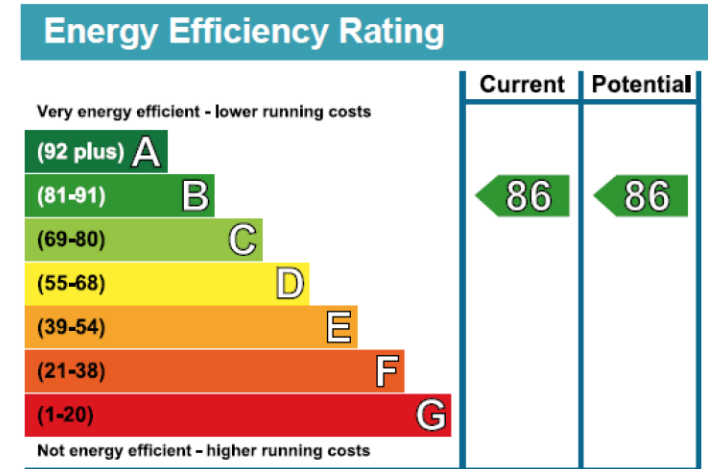
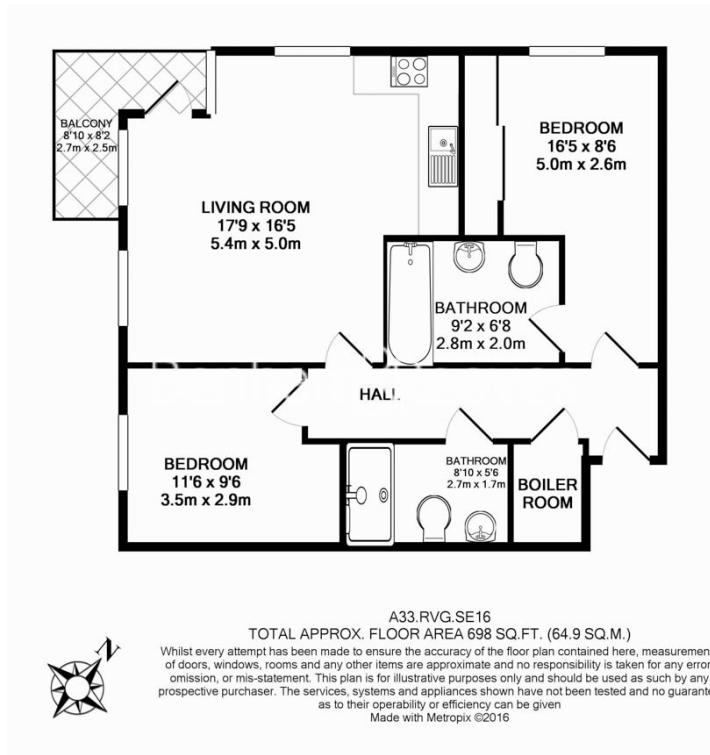

## London branches open six days a week Mon - Sat

Canary Wharf | City | Colindale | Dartmouth Park | Ealing | Fulham  
Hammersmith | Hampstead | Highgate | Hyde Park | Kensington | Kew  
Knightsbridge | Nine Elms | Shoreditch | Southall | Surrey Quays  
Wapping | Wembley | White City | Woolwich

## International offices

China | Hong Kong SAR | India | Indonesia | Israel | Malaysia | Middle East | Pakistan  
Qatar | Singapore | South Africa | Thailand | Turkey

