



Benham & Reeves

**Abell House, Westminster, SW1P**

£1,550 per week, £6,717 per month + fees

 2 Bedrooms    2 Bathrooms    Furnished

A stunning 1,484 sq ft TWO-BEDROOM modern apartment featuring wood flooring in main areas, garden views & private balcony. Situated on the 4th floor of ABELL HOUSE in the heart of Westminster, residents benefit from 24-Hr Concierge, luxury Health Club, Spa & Swimming Pool. Includes secure underground PARKING.

Please [click here](#) for full detail

## Property features

**2 Bedrooms | 2 Bathrooms | Reception | Furnished | Fully-Fitted Kitchen | EPC-B | 1,484 Sq Ft | Secure Parking Space | Luxury Fitness Suite & Swimming Pool | Nearby Westminster and Pimlico Station**

For more information about this property, please call our Knightsbridge branch on

**020 7581 2112**

Redress & Client Money Protection :

Benham and Reeves are members of The Property Ombudsman redress scheme and have Client Money protection with ARLA Propertymark. You can find more information on our website at <https://www.benhams.com/membership/>



Benham & Reeves



# Abell House, Westminster, SW1P

£1,550 per week, £6,717 per month + fees

www.benhams.com

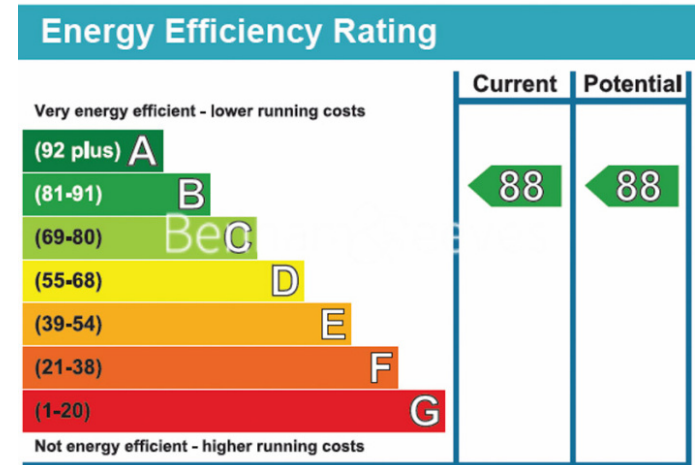
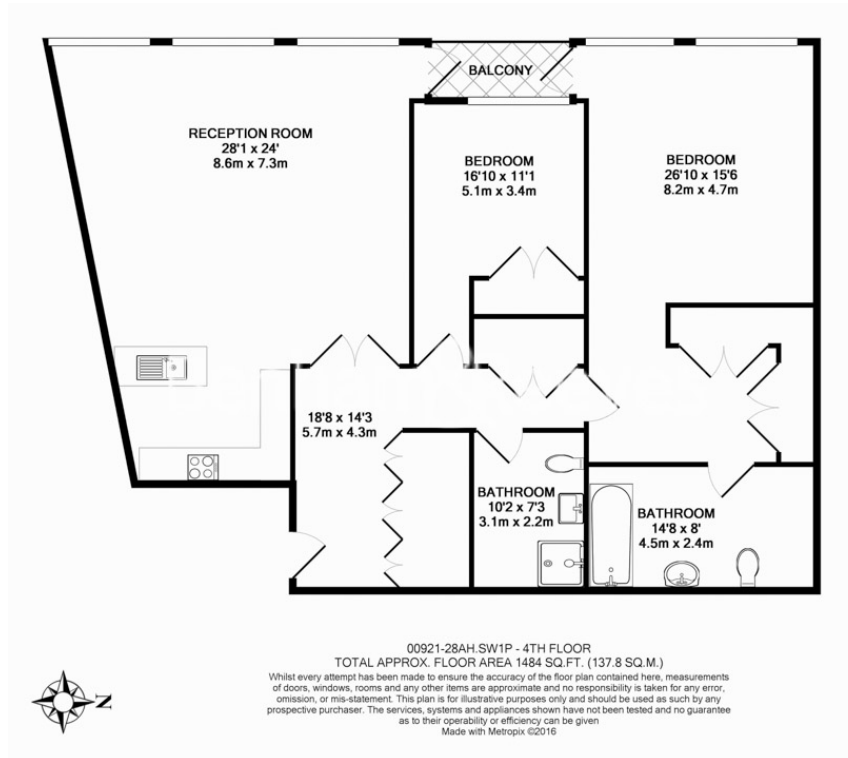

## London branches open six days a week Mon - Sat

Canary Wharf | City | Colindale | Dartmouth Park | Ealing | Fulham  
Hammersmith | Hampstead | Highgate | Hyde Park | Kensington | Kew  
Knightsbridge | Nine Elms | Shoreditch | Southall | Surrey Quays  
Wapping | Wembley | White City | Woolwich

## International offices

China | Hong Kong SAR | India | Indonesia | Qatar | Malaysia | Middle East | Pakistan  
Singapore | South Africa | Thailand | Turkey

