



Benham & Reeves

Garnet Street, Wapping, E1W

£425 per week, £1,842 per month + fees

 1 Bedroom  1 Bathroom  Furnished

Larger than average, presentable apartment, with negotiable parking space, in the heart of Wapping, ideally located for easy access into the City, Shoreditch and or Canary Wharf. (Parking available separately). A short walk from Wapping Station.

Please [click here](#) for full detail

Property features

One Bed Apartment | Family Size Bathroom | Spacious Bedroom | Open Plan Reception | Furnished | EPC-C | Separate Kitchen | Large Windows Throughout | Carpets Throughout | Close To Wapping Station

For more information about this property, please call our Wapping branch on

020 7680 8900

Redress & Client Money Protection :

Benham and Reeves are members of The Property Ombudsman redress scheme and have Client Money protection with ARLA Propertymark. You can find more information on our website at <https://www.benhams.com/membership/>



Benham & Reeves



Garnet Street, Wapping, E1W

£425 per week, £1,842 per month + fees

www.benhams.com

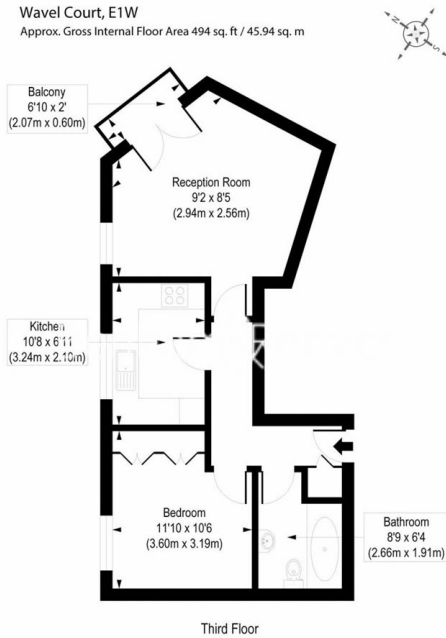

COMPLIANT WITH THE CODE OF MEASURING PRACTICE. Floorplan is for illustrative purposes only and does not constitute any warranty. The accuracy of the floorplan, however, is not intended to be a warranty. The accuracy of the floorplan is not intended to be a warranty. The accuracy of the floorplan is not intended to be a warranty. The accuracy of the floorplan is not intended to be a warranty.

Score	Energy rating	Current	Potential
92+	A		
81-91	B		
69-80	C	73 C	73 C
55-68	D		
39-54	E		
21-38	F		
1-20	G		

London branches open six days a week Mon - Sat

Canary Wharf | City | Colindale | Dartmouth Park | Ealing | Fulham
Hammersmith | Hampstead | Highgate | Hyde Park | Kensington | Kew
Knightsbridge | Nine Elms | Shoreditch | Southall | Surrey Quays
Wapping | Wembley | White City | Woolwich

International offices

China | Hong Kong SAR | India | Indonesia | Qatar | Malaysia | Middle East | Pakistan
Singapore | South Africa | Thailand | Turkey

