



Benham & Reeves

Accolade Avenue, Southall, UB1

£347 per week, £1,504 per month + fees

 1 Bedroom  1 Bathroom  Furnished

Conveniently located 2nd floor suite style apartment situated within an outstanding Berkeley development on the Western fringe of London, featuring great views of the surrounding landscaped gardens.

Please [click here](#) for full detail

Property features

Suite Style Apartment | Concierge | Gym | Cinema room | Residents lounge | EPC-B | Balcony | Full Height Windows | Southall Amenities | Southall Station

For more information about this property, please call our Southall branch on

020 8051 0800

Redress & Client Money Protection :

Benham and Reeves are members of The Property Ombudsman redress scheme and have Client Money protection with ARLA Propertymark. You can find more information on our website at <https://www.benhams.com/membership/>



Benham & Reeves

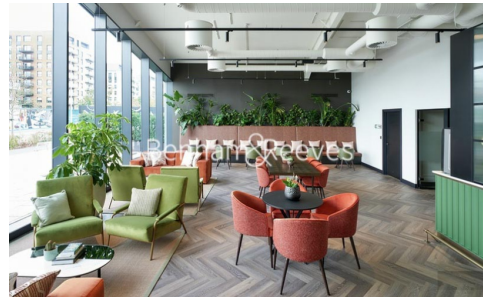
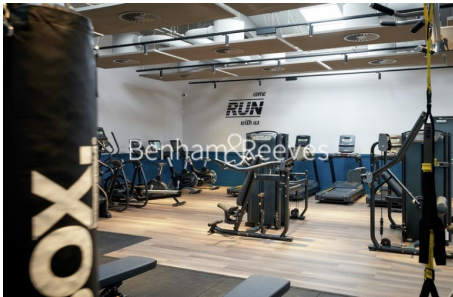

Accolade Avenue, Southall, UB1

£347 per week, £1,504 per month + fees

www.benhams.com

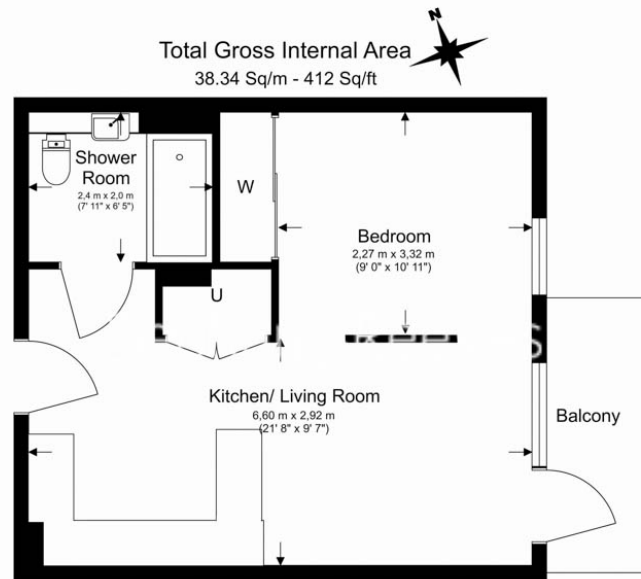

Floor Plan measurements are approximate and are for illustrative purposes only. While we do not doubt the floor plans accuracy we make no guarantee, warranty or representation as to the accuracy and completeness of the floor plan.

Score	Energy rating	Current	Potential
92+	A		
81-91	B	83 B	83 B
69-80	C		
55-68	D		
39-54	E		
21-38	F		
1-20	G		

London branches open six days a week Mon - Sat

Canary Wharf | City | Colindale | Dartmouth Park | Ealing | Fulham
Hammersmith | Hampstead | Highgate | Hyde Park | Kensington | Kew
Knightsbridge | Nine Elms | Shoreditch | Southall | Surrey Quays
Wapping | Wembley | White City | Woolwich

International offices

China | Hong Kong SAR | India | Indonesia | Qatar | Malaysia | Middle East | Pakistan
Singapore | South Africa | Thailand | Turkey

