



Benham & Reeves

Benham & Reeves

Commonwealth Place, Slough, SL2

£415 per week, £1,798 per month + fees

 2 Bedrooms  2 Bathrooms  Furnished

This newly built two-bedroom apartment with parking is in an outstanding Berkeley Development in Farnham Royal, Slough. This is a gated development located close to High Wycombe and for Crossrail at Burnham and Slough Stations on the Elizabeth Line.

Please [click here](#) for full detail

Property features

Brand New | Open Plan Lounge / Kitchen | Gated Development | Master Bedroom with En-suite | Family Bathroom | EPC-D | Allocated Parking | Furnished | Available Now | Nearby Slough Station

For more information about this property,
please call our Southall branch on

020 8051 0800

Redress & Client Money Protection :

Benham and Reeves are members of The Property Ombudsman redress scheme and have Client Money protection with ARLA Propertymark. You can find more information on our website at <https://www.benhams.com/membership/>



Benham & Reeves

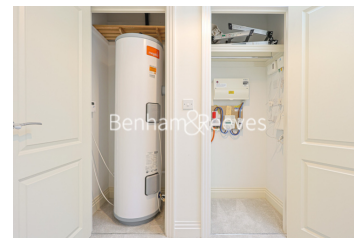

Commonwealth Place, Slough, SL2

£415 per week, £1,798 per month + fees

www.benhams.com

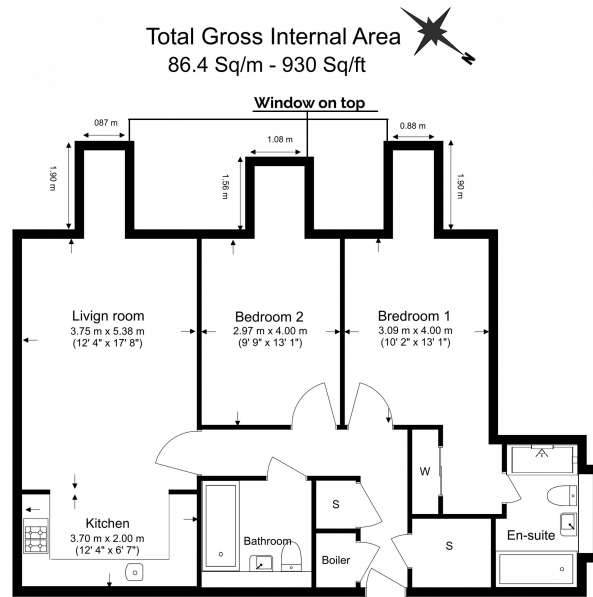

Benham & Reeves

Floor Plan measurements are approximate and are for illustrative purposes only. While we do not doubt the floor plans accuracy, we make no guarantee, warranty or representation as to the accuracy and completeness of the floor plan.

Score	Energy rating	Current	Potential
92+	A		
81-91	B		
69-80	C		
55-68	D	68 D	68 D
39-54	E		
21-38	F		
1-20	G		

London branches open six days a week Mon - Sat

Canary Wharf | City | Colindale | Dartmouth Park | Ealing | Fulham
Hammersmith | Hampstead | Highgate | Hyde Park | Kensington | Kew
Knightsbridge | Nine Elms | Shoreditch | Southall | Surrey Quays
Wapping | Wembley | White City | Woolwich

International offices

China | Hong Kong SAR | India | Indonesia | Israel | Malaysia | Middle East | Pakistan
Qatar | Singapore | South Africa | Thailand | Turkey



Benham & Reeves