



Benham & Reeves

Brigadier Walk, Royal Arsenal Riverside, SE18

£646 per week, £2,800 per month + fees

 2 Bedrooms  2 Bathrooms  Furnished

Spacious apartment offering North/West aspects and direct views of the River Thames situated within a magnificent new development on the cusp of the River and four-acre Maribor Park. The new on-site Elizabeth Line station now open, journey times into the City, West and Heathrow Airport are faster than ever before.

Please [click here](#) for full detail

Property features

Stunning 2 Bedroom Riverside Apartment | Spacious Private Balcony With Direct River Views | Bright and Airy Spaces with Open Plan Layout | Dual Aspects with views of the River Thames | High Quality Specifications Including Integrated Siemens | EPC-B | Swimming pool, gymnasium, spa, cinema | 24 hours concierge | Moments to Woolwich Tube Station

For more information about this property, please call our Woolwich branch on

020 8051 0700

Redress & Client Money Protection :

Benham and Reeves are members of The Property Ombudsman redress scheme and have Client Money protection with ARLA Propertymark. You can find more information on our website at <https://www.benhams.com/membership/>



Benham & Reeves

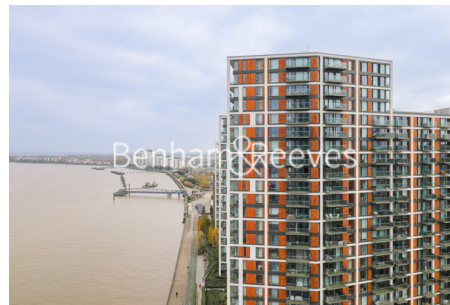

Brigadier Walk, Royal Arsenal Riverside, SE18

£646 per week, £2,800 per month + fees

www.benhams.com

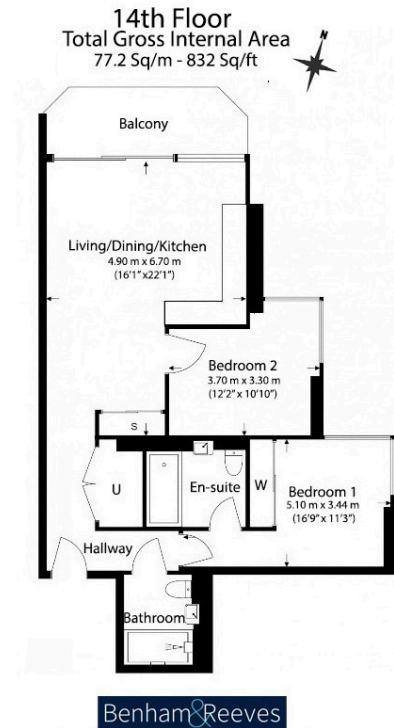

Floor Plan measurements are approximate and are for illustrative purposes only. While we do not doubt the floor plans accuracy, we make no guarantee, warranty or representation as to the accuracy and completeness of the floor plan.

London branches open six days a week Mon - Sat

Canary Wharf | City | Colindale | Dartmouth Park | Ealing | Fulham
Hammersmith | Hampstead | Highgate | Hyde Park | Kensington | Kew
Knightsbridge | Nine Elms | Shoreditch | Southall | Surrey Quays
Wapping | Wembley | White City | Woolwich

International offices

China | Hong Kong SAR | India | Indonesia | Qatar | Malaysia | Middle East | Pakistan
Singapore | South Africa | Thailand | Turkey



Benham & Reeves