



Benham & Reeves

Gillespie Court, Queensland Terrace, N7

£450 per week, £1,950 per month + fees

 1 Bedroom  1 Bathroom  Furnished

A luxury Manhattan style apartment set in this Islington's iconic Queensland Terrace, a striking residential development of three distinctive towers adjacent to Arsenal's world famous Emirates Stadium.

Please [click here](#) for full detail

Property features

Manhattan Style Apartment | Luxury Bathroom | Secluded Bedroom With Built In Wardrobes | Wood Floors Throughout | Fully Fitted Modern Kitchen | EPC-C | Open Plan Kitchen/Reception Room | 24/7 Concierge | Close To Transport And Amenities | Nearby Arsenal underground stations

For more information about this property,
please call our Highgate branch on

020 8341 2335

Redress & Client Money Protection :

Benham and Reeves are members of The Property Ombudsman redress scheme and have Client Money protection with ARLA Propertymark. You can find more information on our website at <https://www.benhams.com/membership/>



Benham & Reeves



Gillespie Court, Queensland Terrace, N7

£450 per week, £1,950 per month + fees

www.benhams.com

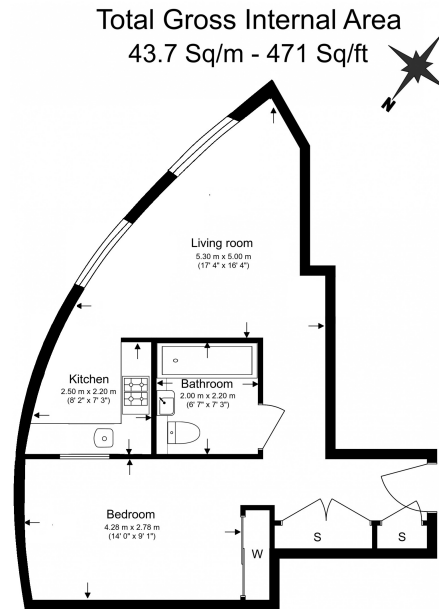

Floor Plan measurements are approximate and are for illustrative purposes only. While we do not doubt the floor plans accuracy, we make no guarantee, warranty or representation as to the accuracy and completeness of the floor plan.

London branches open six days a week Mon - Sat

Canary Wharf | City | Colindale | Dartmouth Park | Ealing | Fulham
Hammersmith | Hampstead | Highgate | Hyde Park | Kensington | Kew
Knightsbridge | Nine Elms | Shoreditch | Southall | Surrey Quays
Wapping | Wembley | White City | Woolwich

International offices

China | Hong Kong SAR | India | Indonesia | Qatar | Malaysia | Middle East | Pakistan
Singapore | South Africa | Thailand | Turkey



Benham & Reeves