



Benham & Reeves

Regency House, North West Quarter, NW6

£750 per week, £3,250 per month + fees

 2 Bedrooms  2 Bathrooms  Furnished

This exceptional 5th floor is situated on the fifth floor of the highly sought-after West Hampstead Central development. Located in Zone 2 and a 7-minute walk from Queen's Park station on the Bakerloo line.

Please [click here](#) for full detail

Property features

Spacious Two Double Bedrooms | Two Modern Bathrooms | Private Balcony with Scenic Views | On-Site Facilities | Concierge Service | EPC-TBC | Prime Zone 2 Location | High-Quality Finishes, including underfloor heating | Home Office-Ready, featuring super-fast Hyperoptic Broadband | Nearby Queen's Park station

For more information about this property, please call our Hampstead branch on

020 7435 9681

Redress & Client Money Protection :

Benham and Reeves are members of The Property Ombudsman redress scheme and have Client Money protection with ARLA Propertymark. You can find more information on our website at <https://www.benhams.com/membership/>



Benham & Reeves



Regency House, North West Quarter, NW6

£750 per week, £3,250 per month + fees

www.benhams.com

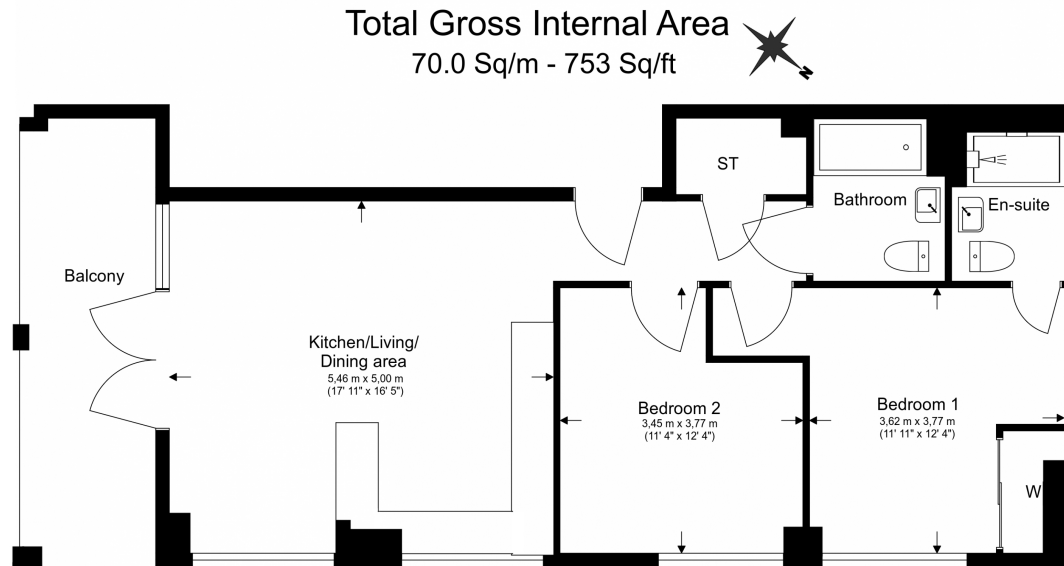

Benham&Reeves

Floor Plan measurements are approximate and are for illustrative purposes only. While we do not doubt the floor plans accuracy, we make no guarantee, warranty or representation as to the accuracy and completeness of the floor plan.

London branches open six days a week Mon - Sat

Canary Wharf | City | Colindale | Dartmouth Park | Ealing | Fulham
Hammersmith | Hampstead | Highgate | Hyde Park | Kensington | Kew
Knightsbridge | Nine Elms | Shoreditch | Southall | Surrey Quays
Wapping | Wembley | White City | Woolwich

International offices

China | Hong Kong SAR | India | Indonesia | Qatar | Malaysia | Middle East | Pakistan
Singapore | South Africa | Thailand | Turkey



Benham&Reeves