



Benham & Reeves

Dean Bradley Street, Nine Elms, SW1P

£1,550 per week, £6,717 per month + fees

 2 Bedrooms  1 Bathroom  Furnished

A spacious apartment situated in an historic Grade II listed building with 5* resident's facilities, located off the River Thames and a short walk from Westminster Village, St James, and Victoria

Please [click here](#) for full detail

Property features

Large living space | High Spec | Fitted kitchen | Balcony | Furnished or Unfurnished | EPC-B | 24 Hour Concierge | Gym | Swimming pool | Westminster, St James Park and Victoria stations

For more information about this property, please call our Nine Elms branch on

020 3282 3700

Redress & Client Money Protection :

Benham and Reeves are members of The Property Ombudsman redress scheme and have Client Money protection with ARLA Propertymark. You can find more information on our website at <https://www.benhams.com/membership/>



Benham & Reeves



Dean Bradley Street, Nine Elms, SW1P

£1,550 per week, £6,717 per month + fees

www.benhams.com

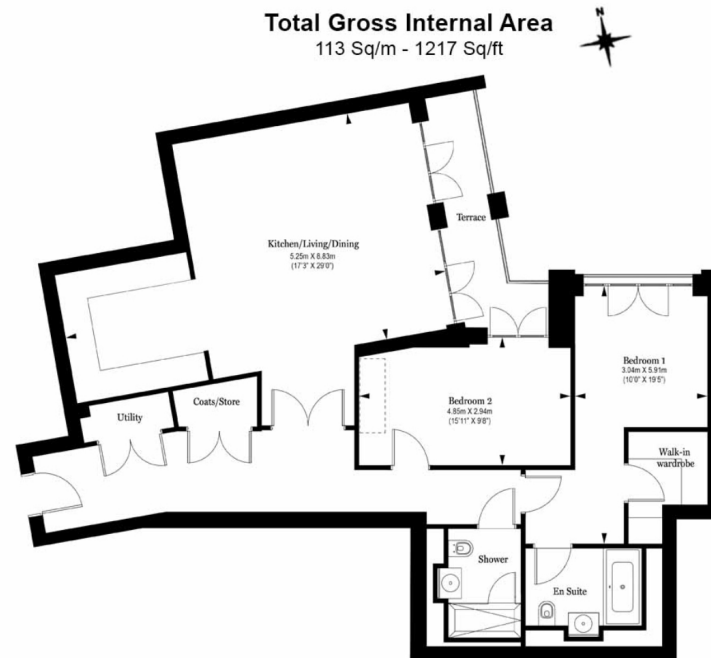

Floor Plan measurements are approximate and are for illustrative purposes only. While we do not doubt the floor plans accuracy we make no guarantee, warranty or representation as to the accuracy and completeness of the floor plan.

Energy Efficiency Rating		
	Current	Potential
<i>Very energy efficient - lower running costs</i>		
(92-100) A		
(81-91) B	82	82
(69-80) C		
(55-68) D		
(39-54) E		
(21-38) F		
(1-20) G		
<i>Not energy efficient - higher running costs</i>		
England & Wales	EU Directive 2002/91/EC	

London branches open six days a week Mon - Sat

Canary Wharf | City | Colindale | Dartmouth Park | Ealing | Fulham
Hammersmith | Hampstead | Highgate | Hyde Park | Kensington | Kew
Knightsbridge | Nine Elms | Shoreditch | Southall | Surrey Quays
Wapping | Wembley | White City | Woolwich

International offices

China | Hong Kong SAR | India | Indonesia | Qatar | Malaysia | Middle East | Pakistan
Singapore | South Africa | Thailand | Turkey



Benham & Reeves