



Benham & Reeves

Embassy Gardens, Nine Elms, SW8

£750 per week, £3,250 per month + fees

 1 Bedroom  1 Bathroom  Furnished

A smart 6th floor apartment situated in a new development in the heart of Nine Elms, located a short walk from Nine Elms Tube Station and Vauxhall Underground Station (Victoria Line) offering direct services to the West End in under ten minutes.

Please [click here](#) for full detail

Property features

One Bedroom Apartment | Balcony | Open planned living | Air cooling | Dishwasher | EPC-B | 24-hour concierge | Swimming Pool | Gym | Nine Elms Tube Station

For more information about this property, please call our Nine Elms branch on

020 3282 3700

Redress & Client Money Protection :

Benham and Reeves are members of The Property Ombudsman redress scheme and have Client Money protection with ARLA Propertymark. You can find more information on our website at <https://www.benhams.com/membership/>



Benham & Reeves



Embassy Gardens, Nine Elms, SW8

£750 per week, £3,250 per month + fees

www.benhams.com

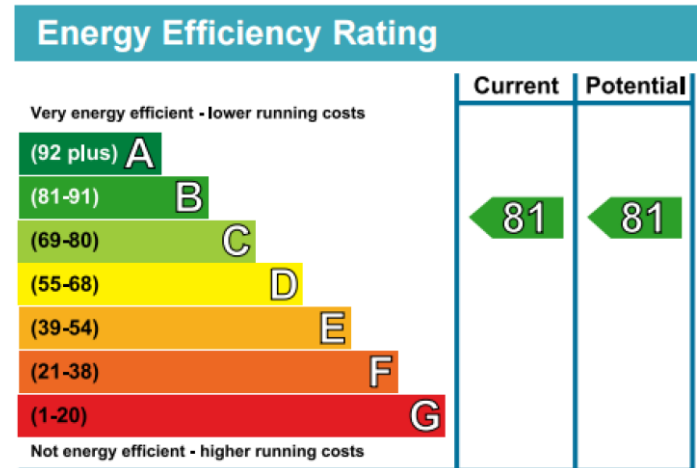
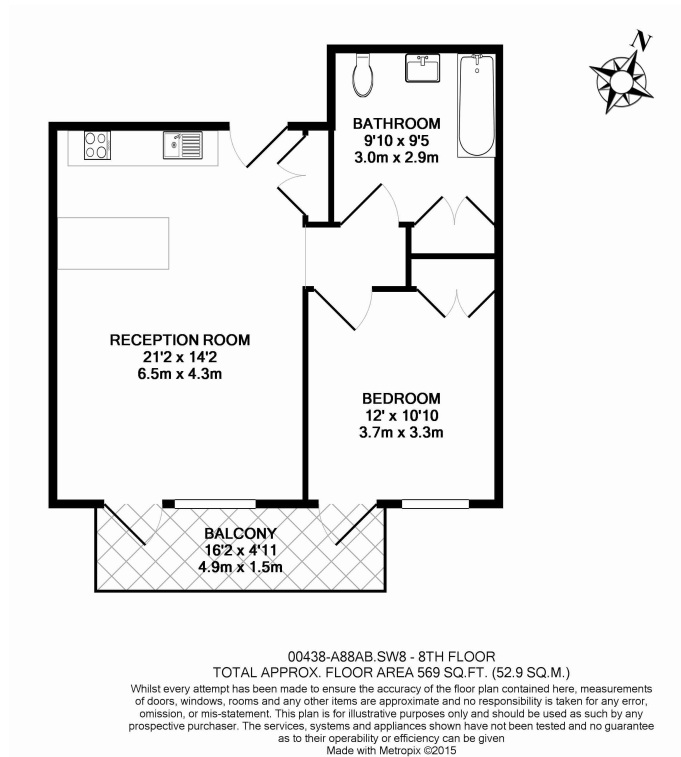

London branches open six days a week Mon - Sat

Canary Wharf | City | Colindale | Dartmouth Park | Ealing | Fulham
Hammersmith | Hampstead | Highgate | Hyde Park | Kensington | Kew
Knightsbridge | Nine Elms | Shoreditch | Southall | Surrey Quays
Wapping | Wembley | White City | Woolwich

International offices

China | Hong Kong SAR | India | Indonesia | Qatar | Malaysia | Middle East | Pakistan
Singapore | South Africa | Thailand | Turkey

