



Benham&Reeves

Marner Point, Jefferson Plaza, E3

£427 per week, £1,850 per month + fees

 1 Bedroom  1 Bathroom  Furnished

A modern spacious apartment located in an enviable development, with communal roof terraces affording spectacular 360-degree views, in Bromley-by-Bow. Well-located for Bromley-by-Bow Underground Station (District and Hammersmith and City lines).

Please [click here](#) for full detail

Property features

One Bedroom | One Bathroom | Open Planned Living | Fitted Kitchen | Furnished | EPC-B | 24 Hour Concierge | Available Future | Residence Gym | Bromley By Bow Station

For more information about this property,
please call our Canary Wharf branch on

020 8036 3200

Redress & Client Money Protection :

Benham and Reeves are members of The Property Ombudsman redress scheme and have Client Money protection with ARLA Propertymark. You can find more information on our website at <https://www.benhams.com/membership/>



Benham & Reeves



Marner Point, Jefferson Plaza, E3

£427 per week, £1,850 per month + fees

www.benhams.com

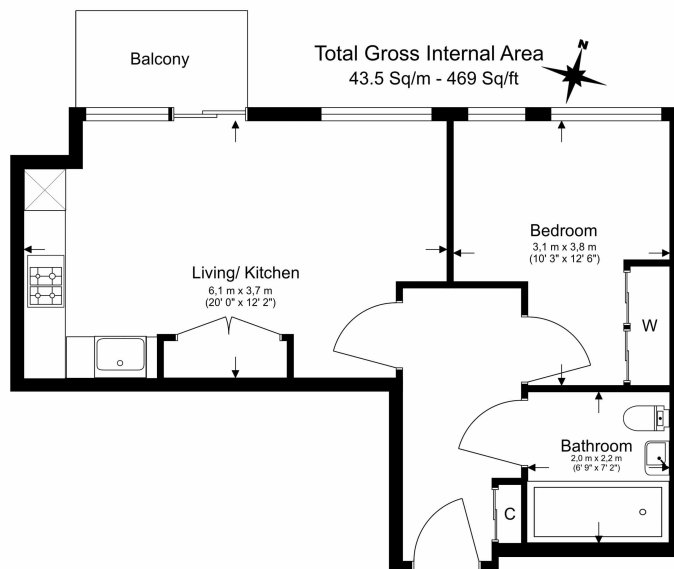

Floor Plan measurements are approximate and are for illustrative purposes only. While we do not doubt the floor plans accuracy, we make no guarantee, warranty or representation as to the accuracy and completeness of the floor plan.

Score	Energy rating	Current	Potential
92+	A		
81-91	B		
69-80	C	77 c	77 c
55-68	D		
39-54	E		
21-38	F		
1-20	G		

London branches open six days a week Mon - Sat

Canary Wharf | City | Colindale | Dartmouth Park | Ealing | Fulham
Hammersmith | Hampstead | Highgate | Hyde Park | Kensington | Kew
Knightsbridge | Nine Elms | Shoreditch | Southall | Surrey Quays
Wapping | Wembley | White City | Woolwich

International offices

China | Hong Kong SAR | India | Indonesia | Qatar | Malaysia | Middle East | Pakistan
Singapore | South Africa | Thailand | Turkey



Benham & Reeves