



Benham & Reeves

Harbour Reach, Imperial Wharf, SW6

£738 per week, £3,200 per month + fees

 2 Bedrooms  2 Bathrooms  Furnished

A bright 2 bed, 2 bath apartment on the 2nd floor of Harbour Reach. The property benefits from huge windows and great views from the living room and balcony. The large balcony is a key feature.

Please [click here](#) for full detail

Property features

2 bedroom | 2 bathroom | Integrated appliances | Furnished | Large living room | EPC-B | 24/7 concierge and security | Large balcony /Communal gardens | Parking included /On-site gym | Imperial Wharf Station

For more information about this property, please call our Fulham branch on

020 7348 7620

Redress & Client Money Protection :

Benham and Reeves are members of The Property Ombudsman redress scheme and have Client Money protection with ARLA Propertymark. You can find more information on our website at <https://www.benhams.com/membership/>



Benham & Reeves

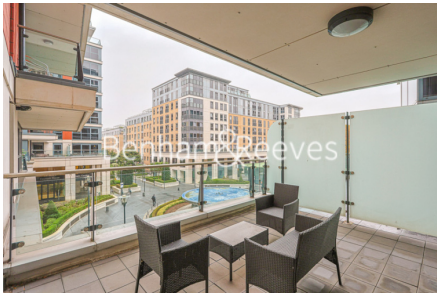

Harbour Reach, Imperial Wharf, SW6

£738 per week, £3,200 per month + fees

www.benhams.com

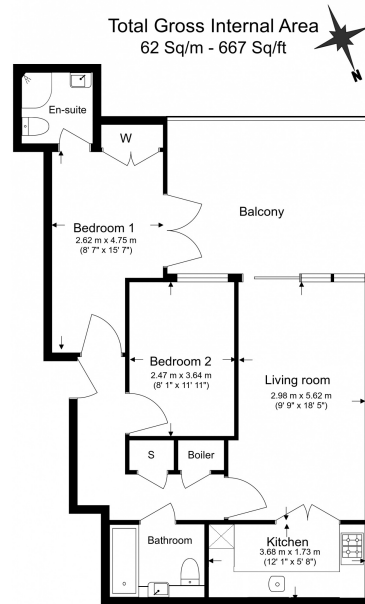

Benham & Reeves

Floor Plan measurements are approximate and are for illustrative purposes only. While we do not doubt the floor plans accuracy, we make no guarantee, warranty or representation as to the accuracy and completeness of the floor plan.

Score	Energy rating	Current	Potential
92+	A		
81-91	B	85 B	85 B
69-80	C		
55-68	D		
39-54	E		
21-38	F		
1-20	G		

London branches open six days a week Mon - Sat

Canary Wharf | City | Colindale | Dartmouth Park | Ealing | Fulham
Hammersmith | Hampstead | Highgate | Hyde Park | Kensington | Kew
Knightsbridge | Nine Elms | Shoreditch | Southall | Surrey Quays
Wapping | Wembley | White City | Woolwich

International offices

China | Hong Kong SAR | India | Indonesia | Qatar | Malaysia | Middle East | Pakistan
Singapore | South Africa | Thailand | Turkey



Benham & Reeves