



Benham & Reeves

Harbour Reach, Imperial Wharf, SW6

£600 per week, £2,600 per month + fees

 2 Bedrooms  2 Bathrooms  Unfurnished

Modern 4th floor apartment in a landmark development with a very large reception room with dining area and access to a balcony. Added benefits include comfort cooling, 24 hour portering and lifts to all floors. EPC-C

Please [click here](#) for full detail

Property features

2 Bedroom | 2 Bathrooms | Reception | Furnished | Fitted Kitchen | EPC-C | Gym Facilities | Comfort Cooling 24 hour Concierge | Fulham Broadway Underground Station

For more information about this property, please call our Fulham branch on

020 7348 7620

Redress & Client Money Protection :

Benham and Reeves are members of The Property Ombudsman redress scheme and have Client Money protection with ARLA Propertymark. You can find more information on our website at <https://www.benhams.com/membership/>



Benham & Reeves



Harbour Reach, Imperial Wharf, SW6

£600 per week, £2,600 per month + fees

www.benhams.com

Total Gross Internal Area
63.11 Sq/m - 679 Sq/ft

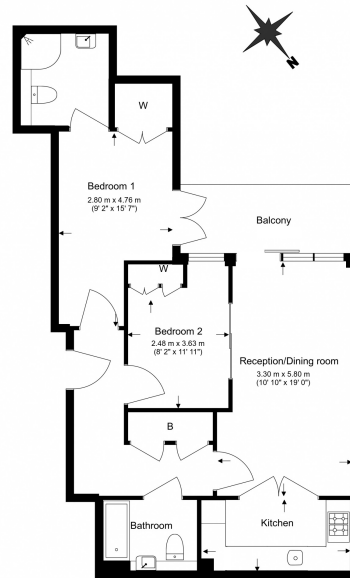

Floor Plan measurements are approximate and are for illustrative purposes only. While we do not doubt the floor plans accuracy, we make no guarantee, warranty or representation as to the accuracy and completeness of the floor plan.

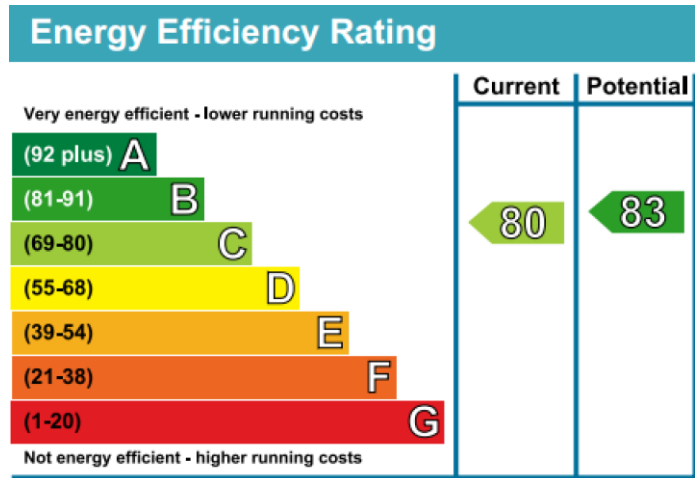

London branches open six days a week Mon - Sat

Canary Wharf | City | Colindale | Dartmouth Park | Ealing | Fulham
Hammersmith | Hampstead | Highgate | Hyde Park | Kensington | Kew
Knightsbridge | Nine Elms | Shoreditch | Southall | Surrey Quays
Wapping | Wembley | White City | Woolwich



International offices

China | Hong Kong SAR | India | Indonesia | Israel | Malaysia | Middle East | Pakistan
Qatar | Singapore | South Africa | Thailand | Turkey