



Benham&Reeves

## Claremont Road, Highgate, N6

£900 per week, £3,900 per month + fees

 4 Bedrooms    2 Bathrooms    Unfurnished

A bright, large family Victorian mid-terrace house in excellent condition near Highgate tube station. The property is in a desirable location and features a well-maintained South facing garden  
Close to Highgate Tube Station (Northern Line).

Please [click here](#) for full detail

## Property features

**4 Double Bedrooms | 1 Large Double Reception Room | Kitchen with Dining Area | 2 Stylish Bathrooms | Unfurnished | EPC-E | Private Garden | South Facing Garden | Nearby Highgate Station**

For more information about this property,  
please call our Highgate branch on

**020 8341 2335**

Redress & Client Money Protection :

Benham and Reeves are members of The Property Ombudsman redress scheme and have Client Money protection with ARLA Propertymark. You can find more information on our website at <https://www.benhamandreeves.com/membership/>



**Benham & Reeves**





# Claremont Road, Highgate, N6

£900 per week, £3,900 per month + fees

[www.benhams.com](http://www.benhams.com)

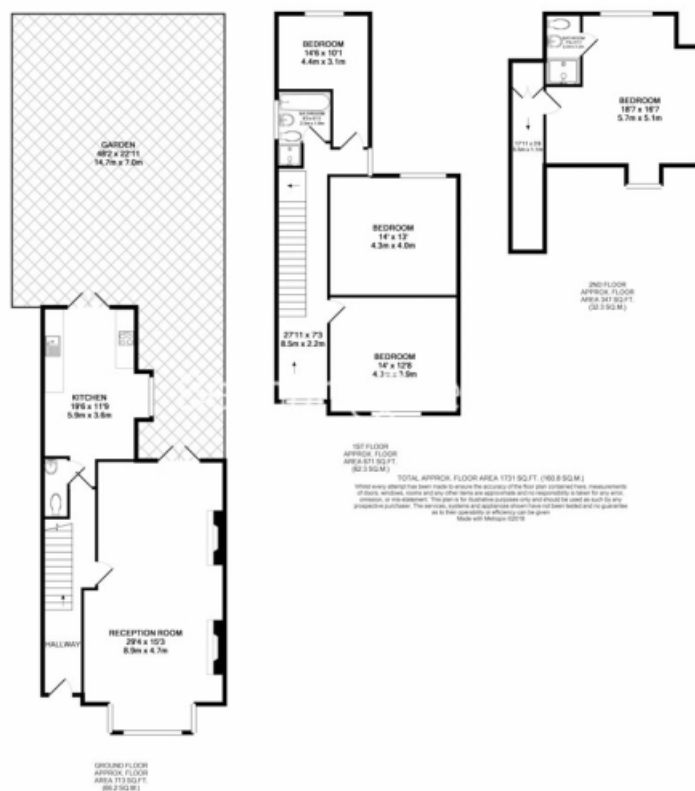

Energy Efficiency Rating		
	Current	Potential
Very energy efficient - lower running costs		
(92 plus) A		
(81-91) B		
(69-80) C		
(55-68) D		
(39-54) E	51	53
(21-38) F		
(1-20) G		
Not energy efficient - higher running costs		
England & Wales		EU Directive 2002/91/EC

## London branches open six days a week Mon - Sat

Canary Wharf | City | Colindale | Dartmouth Park | Ealing | Fulham  
Hammersmith | Hampstead | Highgate | Hyde Park | Kensington | Kew  
Knightsbridge | Nine Elms | Shoreditch | Southall | Surrey Quays  
Wapping | Wembley | White City | Woolwich

## International offices

China | Hong Kong SAR | India | Indonesia | Qatar | Malaysia | Middle East | Pakistan  
Singapore | South Africa | Thailand | Turkey



Benham & Reeves