



Benham & Reeves

Carnation Gardens, Hayes, UB3

£485 per week, £2,102 per month + fees

 2 Bedrooms  2 Bathrooms  Furnished

Stylish 4th floor apartment, with private terrace, situated in an exciting development a brief walk from Hayes and Harlington Station, a strategic stop on the new super-fast Elizabeth Line.

Please [click here](#) for full detail

Property features

Two Bedroom Apartment | Two Bathroom | Reception | Modern kitchen | Residents gym | EPC-B | Wood floors | Terrace | Hayes and Harlington Station

For more information about this property,
please call our Southall branch on

020 8051 0800

Redress & Client Money Protection :

Benham and Reeves are members of The Property Ombudsman redress scheme and have Client Money protection with ARLA Propertymark. You can find more information on our website at <https://www.benhamandreeves.com/membership/>



Benham & Reeves



Carnation Gardens, Hayes, UB3

£485 per week, £2,102 per month + fees

www.benhams.com

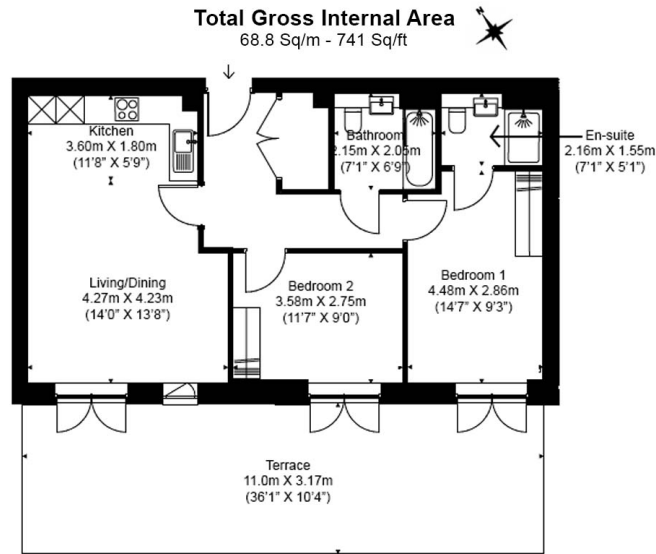

Floor Plan measurements are approximate and are for illustrative purposes only. While we do not doubt the floor plans accuracy, we make no guarantee, warranty or representation as to the accuracy and completeness of the floor plan.

| Score | Energy rating | Current | Potential |
|-------|---------------|---------|-----------|
| 92+ | A | | |
| 81-91 | B | 85 B | 85 B |
| 69-80 | C | | |
| 55-68 | D | | |
| 39-54 | E | | |
| 21-38 | F | | |
| 1-20 | G | | |

London branches open six days a week Mon - Sat

Canary Wharf | City | Colindale | Dartmouth Park | Ealing | Fulham
Hammersmith | Hampstead | Highgate | Hyde Park | Kensington | Kew
Knightsbridge | Nine Elms | Shoreditch | Southall | Surrey Quays
Wapping | Wembley | White City | Woolwich

International offices

China | Hong Kong SAR | India | Indonesia | Qatar | Malaysia | Middle East | Pakistan
Singapore | South Africa | Thailand | Turkey



Benham & Reeves