



Benham & Reeves

Middle Road, Hanwell, W7

£416 per week, £1,803 per month + fees

 1 Bedroom  1 Bathroom  Unfurnished

A modern 3rd floor apartment, with excellent residents' amenities, situated within a highly popular development in Hanwell. Conveniently situated within walking distance from Hanwell station (Elizabeth line).

Please [click here](#) for full detail

Property features

One Bedroom | One Bathroom | Reception | Concierge | Gym | EPC-C | Balcony | Wood floors | Modern development | Nearby Hanwell station

For more information about this property,
please call our Ealing branch on

020 8280 0140

Redress & Client Money Protection :

Benham and Reeves are members of The Property Ombudsman redress scheme and have Client Money protection with ARLA Propertymark. You can find more information on our website at <https://www.benhamandreeves.com/membership/>



Benham & Reeves



Middle Road, Hanwell, W7

£416 per week, £1,803 per month + fees

www.benhams.com

Total Gross Internal Area
49.3 Sq/m - 531 Sq/ft

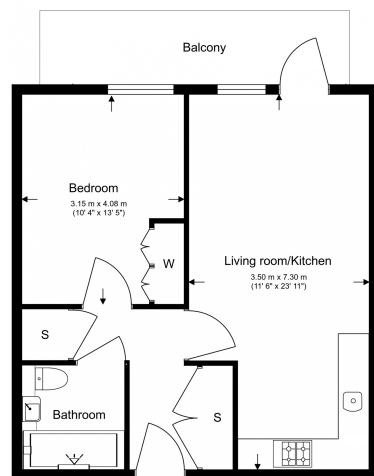

Floor Plan measurements are approximate and are for illustrative purposes only. While we do not doubt the floor plans accuracy, we make no guarantee, warranty or representation as to the accuracy and completeness of the floor plan.

Score	Energy rating	Current	Potential
92+	A		
81-91	B	85 B	85 B
69-80	C		
55-68	D		
39-54	E		
21-38	F		
1-20	G		

London branches open six days a week Mon - Sat

Canary Wharf | City | Colindale | Dartmouth Park | Ealing | Fulham
Hammersmith | Hampstead | Highgate | Hyde Park | Kensington | Kew
Knightsbridge | Nine Elms | Shoreditch | Southall | Surrey Quays
Wapping | Wembley | White City | Woolwich

International offices

China | Hong Kong SAR | India | Indonesia | Qatar | Malaysia | Middle East | Pakistan
Singapore | South Africa | Thailand | Turkey



Benham & Reeves