



Benham & Reeves

Hornby Close, Hampstead ,NW3

£1,327 per week, £5,750 per month + fees

 5 Bedrooms  3 Bathrooms  Unfurnished

A stunning, large, recently renovated 3 story townhouse, with private patio garden and private permit parking in this exclusive residential square just steps from Swiss Cottage Underground Station.

Please [click here](#) for full detail

Property features

A spacious 1743sqft 3 storey-townhouse located | 5 bedrooms 3 bathrooms, spacious 588sqft lounge on the 1st | Exceptionally large kitchen dining with all integrated | Spacious private rear patio garden, access from kitchen | Recently fully renovated in 2021 | EPC-C | Modern bathrooms with a spacious bathtub and 2 walk-in showers | Plenty of natural lights from all windows facing to both | Private permit parking available for the residents | Easy access to Swiss Cottage underground station

For more information about this property,
please call our Hampstead branch on

020 7435 9681





Hornby Close, Hampstead ,NW3

£1,327 per week, £5,750 per month + fees

www.benhams.com

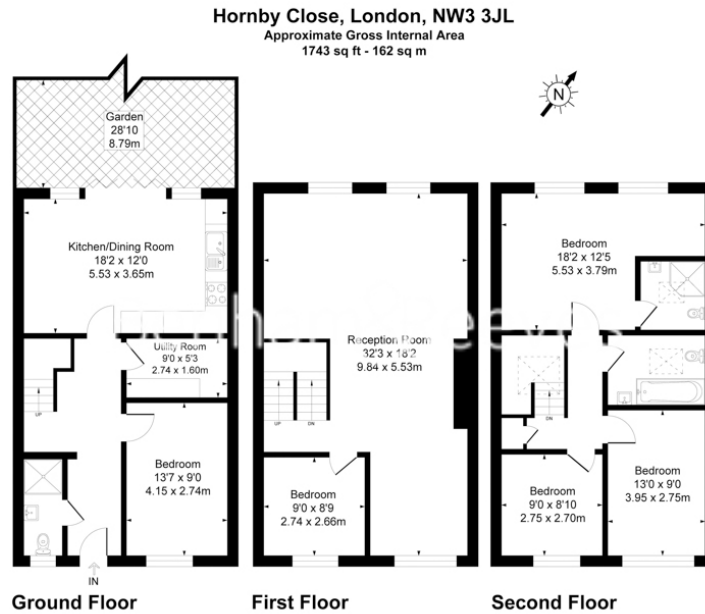

Illustration for identification purposes only, not to scale

Score	Energy rating	Current	Potential
92+	A		
81-91	B		81 B
69-80	C	72 C	
55-68	D		
39-54	E		
21-38	F		
1-20	G		

London branches open six days a week Mon - Sat

Canary Wharf | City | Colindale | Dartmouth Park | Ealing | Fulham
Hammersmith | Hampstead | Highgate | Hyde Park | Kensington | Kew
Knightsbridge | Nine Elms | Shoreditch | Southall | Surrey Quays
Wapping | Wembley | White City | Woolwich



International offices

China | Hong Kong SAR | India | Indonesia | Israel | Malaysia | Middle East | Pakistan
Qatar | Singapore | South Africa | Thailand | Turkey