



Benham & Reeves

## **The Panoramic, Hampstead, NW3**

£1,200 per week, £5,200 per month + fees

 2 Bedrooms    2 Bathrooms    Furnished

This extraordinary 3rd floor penthouse apartment, with lift and secure parking, situated in the heart of Hampstead a brief walk to Hampstead Heath.

Please [click here](#) for full detail

## Property features

**2 Bedrooms | 2 Bathrooms | Open Plan Reception Room And Luxury Kitchen | Concierge Services | En Suite Main Bedroom | EPC-B | Secure Allocated Underground Parking Space | Private Terrace | Easy Access to Shopping Facilities | Nearby Hampstead Heath Overground Station**

For more information about this property, please call our Hampstead branch on

**020 7435 9681**

Redress & Client Money Protection :

Benham and Reeves are members of The Property Ombudsman redress scheme and have Client Money protection with ARLA Propertymark. You can find more information on our website at <https://www.benhams.com/membership/>



Benham & Reeves



# The Panoramic, Hampstead, NW3

£1,200 per week, £5,200 per month + fees

www.benhams.com

APPROXIMATE FLOOR AREA = 970 SQ FT / 90.1 SQ M  
INCLUDING LIMITED USE AREA (6 SQ FT / 0.6 SQ M)

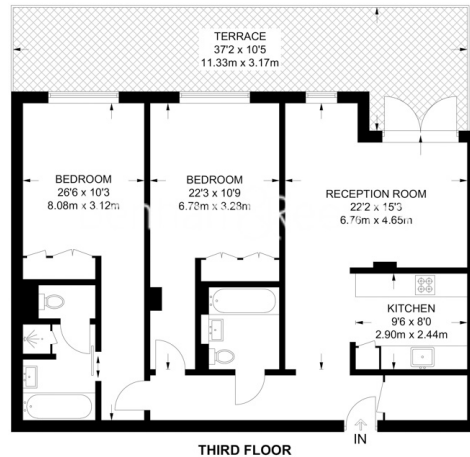

Surveyed and drawn in accordance with the International Property Measurement Standards (IPMS 2: Residential) FOXTONS.CO.UK



Score	Energy rating	Current	Potential
92+	A		
81-91	B	84 B	84 B
69-80	C		
55-68	D		
39-54	E		
21-38	F		
1-20	G		

## London branches open six days a week Mon - Sat

Canary Wharf | City | Colindale | Dartmouth Park | Ealing | Fulham  
Hammersmith | Hampstead | Highgate | Hyde Park | Kensington | Kew  
Knightsbridge | Nine Elms | Shoreditch | Southall | Surrey Quays  
Wapping | Wembley | White City | Woolwich

## International offices

China | Hong Kong SAR | India | Indonesia | Qatar | Malaysia | Middle East | Pakistan  
Singapore | South Africa | Thailand | Turkey

