



Benham & Reeves

Sovereign Court, Hammersmith, W6

£750 per week, £3,250 per month + fees

 2 Bedrooms  2 Bathrooms  Furnished

A luxury, air-conditioned 2nd floor apartment situated within an exclusive development in the heart of Hammersmith. Ideally located within walking distance from Hammersmith underground station 9Circle, District, Piccadilly and Hammersmith and City lines.

Please [click here](#) for full detail

Property features

Two Bedrooms | Two Bathrooms | Reception | Furnished | Fitted Kitchen | EPC-B | 24 hours Concierge Service | Fully Equipped Residences Gymnasium | 2 Minute Walk To Hammersmith Tube Station

For more information about this property, please call our Hammersmith branch on

020 8600 0960

Redress & Client Money Protection :

Benham and Reeves are members of The Property Ombudsman redress scheme and have Client Money protection with ARLA Propertymark. You can find more information on our website at <https://www.benhams.com/membership/>



Benham & Reeves



Sovereign Court, Hammersmith, W6

£750 per week, £3,250 per month + fees

www.benhams.com

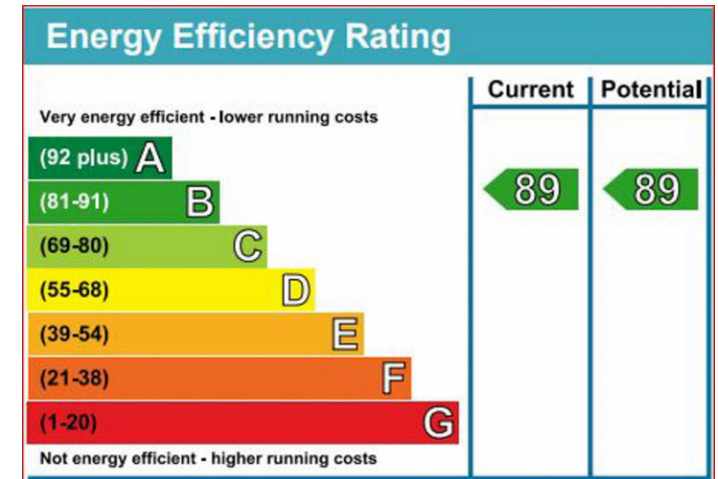
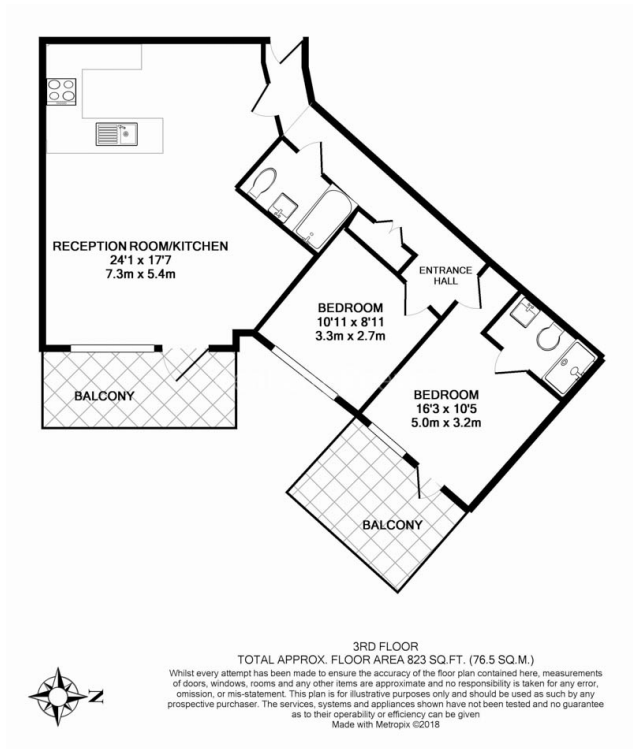

London branches open six days a week Mon - Sat

Canary Wharf | City | Colindale | Dartmouth Park | Ealing | Fulham
Hammersmith | Hampstead | Highgate | Hyde Park | Kensington | Kew
Knightsbridge | Nine Elms | Shoreditch | Southall | Surrey Quays
Wapping | Wembley | White City | Woolwich

International offices

China | Hong Kong SAR | India | Indonesia | Qatar | Malaysia | Middle East | Pakistan
Singapore | South Africa | Thailand | Turkey

