



Benham & Reeves

Sovereign Court, Hammersmith, W6

£700 per week, £3,033 per month + fees

 2 Bedrooms  2 Bathrooms  Furnished

A spacious luxury, air-conditioned 8th floor apartment is situated in the prestigious development in the heart of Hammersmith. Ideally located within walking distance from Hammersmith Underground station (Circle, District, Piccadilly and Hammersmith and City lines).

Please [click here](#) for full detail

Property features

2 Bedrooms | 2 Bathrooms | Reception | Furnished | Fitted Kitchen | EPC-B | Close to Amenities | 24 hr Concierge / Quality Residents' Gym | Nearby Hammersmith Underground Station & Local Buses

For more information about this property, please call our Hammersmith branch on

020 8600 0960

Redress & Client Money Protection :

Benham and Reeves are members of The Property Ombudsman redress scheme and have Client Money protection with ARLA Propertymark. You can find more information on our website at <https://www.benhams.com/membership/>



Benham & Reeves



Sovereign Court, Hammersmith, W6

£700 per week, £3,033 per month + fees

www.benhams.com

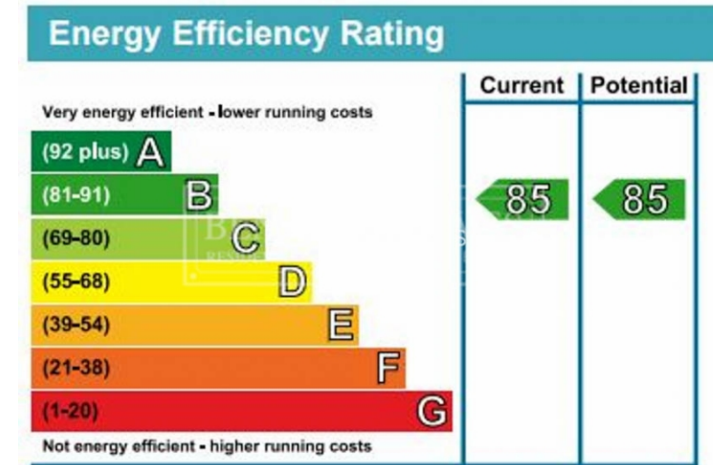
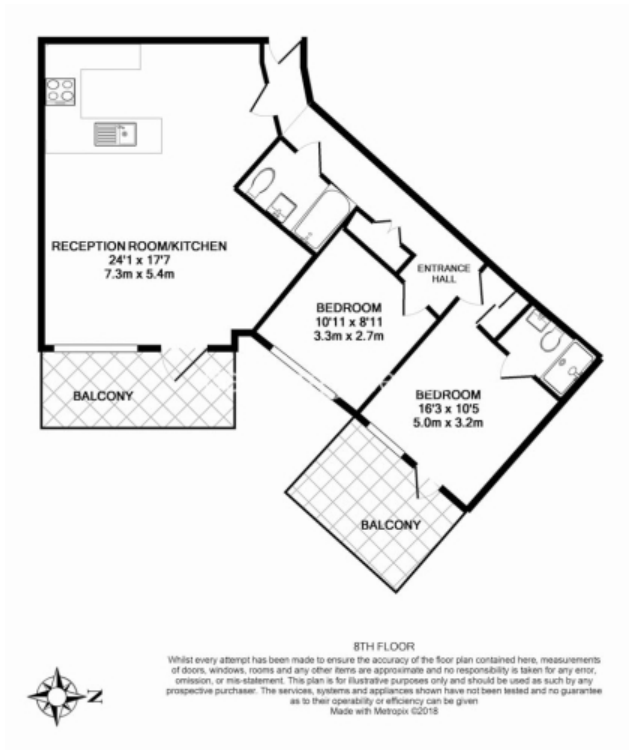

London branches open six days a week Mon - Sat

Canary Wharf | City | Colindale | Dartmouth Park | Ealing | Fulham
Hammersmith | Hampstead | Highgate | Hyde Park | Kensington | Kew
Knightsbridge | Nine Elms | Shoreditch | Southall | Surrey Quays
Wapping | Wembley | White City | Woolwich

International offices

China | Hong Kong SAR | India | Indonesia | Qatar | Malaysia | Middle East | Pakistan
Singapore | South Africa | Thailand | Turkey

