



Benham & Reeves

Park Street, Fulham, SW6

£565 per week, £2,450 per month + fees

 Studio  1 Bathroom  Furnished

A contemporary Manhattan apartment set in a landmark riverside development close to the amenities of Fulham and Chelsea. The development is conveniently situated moments away from Imperial Wharf overground station.

Please [click here](#) for full detail

Property features

Manhattan | 1 Bathroom | Open Plan Reception | Furnished | Fitted Kitchen | EPC-C | Balcony | 24 Hour Concierge | Nearby Imperial Wharf (Overground)

For more information about this property, please call our Fulham branch on

020 7348 7620

Redress & Client Money Protection :

Benham and Reeves are members of The Property Ombudsman redress scheme and have Client Money protection with ARLA Propertymark. You can find more information on our website at <https://www.benhams.com/membership/>



Benham & Reeves



Park Street, Fulham, SW6

£565 per week, £2,450 per month + fees

www.benhams.com

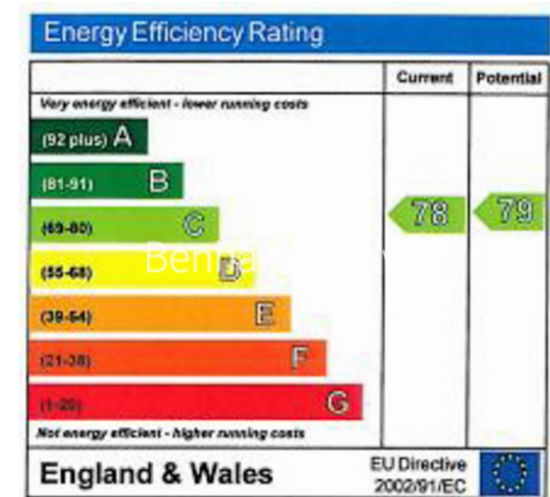
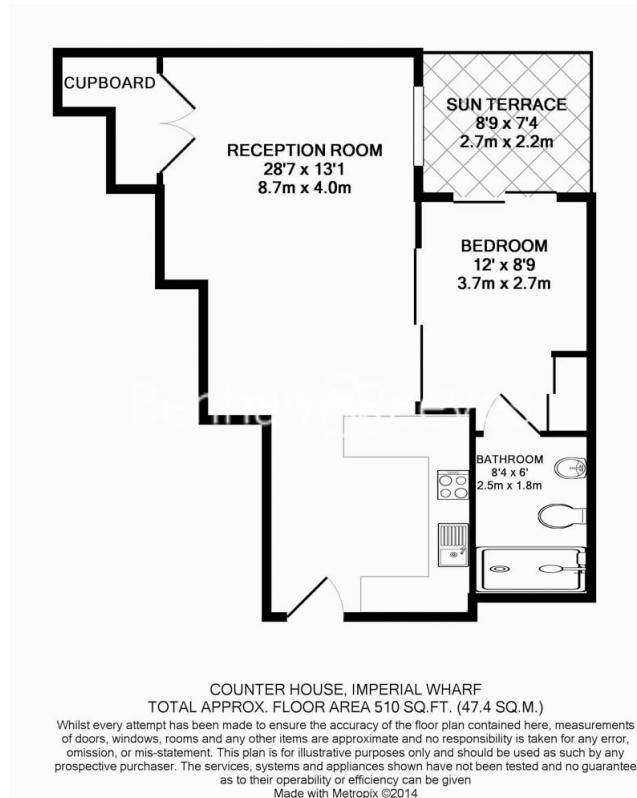

London branches open six days a week Mon - Sat

Canary Wharf | City | Colindale | Dartmouth Park | Ealing | Fulham
Hammersmith | Hampstead | Highgate | Hyde Park | Kensington | Kew
Knightsbridge | Nine Elms | Shoreditch | Southall | Surrey Quays
Wapping | Wembley | White City | Woolwich

International offices

China | Hong Kong SAR | India | Indonesia | Qatar | Malaysia | Middle East | Pakistan
Singapore | South Africa | Thailand | Turkey



Benham & Reeves