



Benham & Reeves

Imperial Wharf, Fulham, SW6

£773 per week, £3,350 per month + fees

 2 Bedrooms  2 Bathrooms  Furnished

Contemporary seventh floor apartment with direct River views and communal gardens in Fulham. Ideally located minutes from Imperial Wharf Overground Station and Fulham Broadway Tube station (District Line).

Please [click here](#) for full detail

Property features

2 Bedrooms | 2 Bathrooms | Reception | Furnished | Fitted Kitchen | EPC-C | Parking Included | Residents' Gym | 24 Hour Concierge | Nearby Imperial Wharf Station

For more information about this property, please call our Fulham branch on

020 7348 7620

Redress & Client Money Protection :
Benham and Reeves are members of The Property Ombudsman redress scheme and have Client Money protection with ARLA Propertymark.
You can find more information on our website at <https://www.benhamandreeves.com/membership/>



Benham & Reeves



Imperial Wharf, Fulham, SW6

£773 per week, £3,350 per month + fees

www.benhams.com

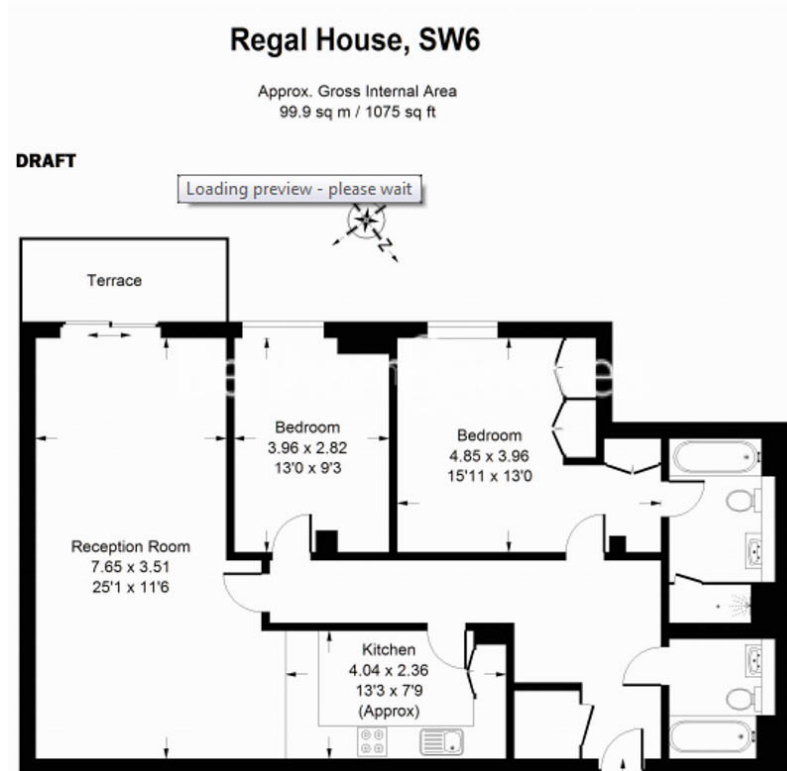

on fact costs and environmental impact based on a

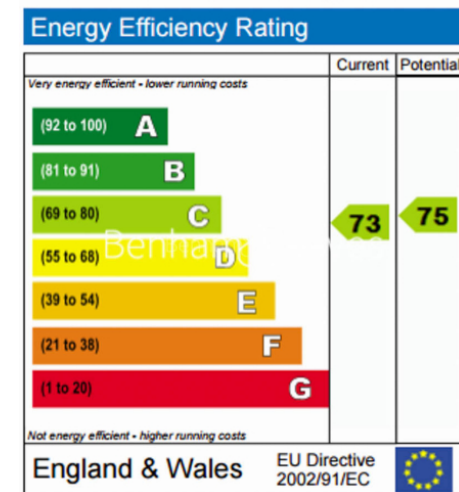

London branches open six days a week Mon - Sat

Canary Wharf | City | Colindale | Dartmouth Park | Ealing | Fulham
Hammersmith | Hampstead | Highgate | Hyde Park | Kensington | Kew
Knightsbridge | Nine Elms | Shoreditch | Southall | Surrey Quays
Wapping | Wembley | White City | Woolwich

International offices

China | Hong Kong SAR | India | Indonesia | Qatar | Malaysia | Middle East | Pakistan
Singapore | South Africa | Thailand | Turkey

