



Benham & Reeves

New Broadway, Ealing, W5

£716 per week, £3,103 per month + fees

 2 Bedrooms  2 Bathrooms  Furnished

A stunning spacious apartment situated in a highly popular development in the heart of Ealing Broadway, W5. Just a few steps from Ealing Broadway station (Elizabeth, Central and District lines), which offer access to the west end in just 20 minutes.

Please [click here](#) for full detail

Property features

Two bedrooms | Underground parking | Furnished | Interior designed | Gym | EPC-B | 24hr concierge | Swimming pool | Close to Station

For more information about this property, please call our Ealing branch on

020 8280 0140

Redress & Client Money Protection :

Benham and Reeves are members of The Property Ombudsman redress scheme and have Client Money protection with ARLA Propertymark. You can find more information on our website at <https://www.benhams.com/membership/>



Benham & Reeves



New Broadway, Ealing, W5

£716 per week, £3,103 per month + fees

www.benhams.com

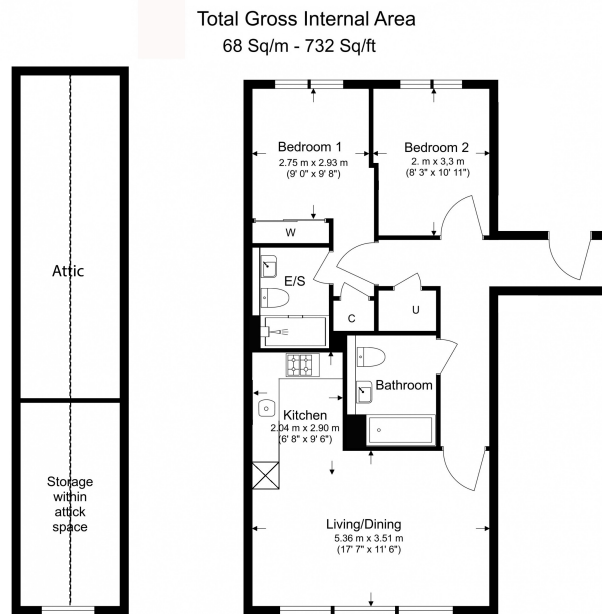

Benham & Reeves

Floor Plan measurements are approximate and are for illustrative purposes only. While we do not doubt the floor plans accuracy, we make no guarantee, warranty or representation as to the accuracy and completeness of the floor plan.

Energy Efficiency Rating

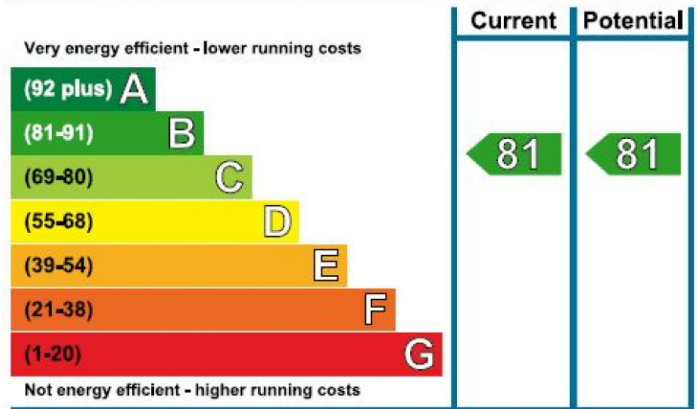

London branches open six days a week Mon - Sat

Canary Wharf | City | Colindale | Dartmouth Park | Ealing | Fulham
Hammersmith | Hampstead | Highgate | Hyde Park | Kensington | Kew
Knightsbridge | Nine Elms | Shoreditch | Southall | Surrey Quays
Wapping | Wembley | White City | Woolwich

International offices

China | Hong Kong SAR | India | Indonesia | Qatar | Malaysia | Middle East | Pakistan
Singapore | South Africa | Thailand | Turkey



Benham & Reeves