



Benham & Reeves

Capitol Way, Colindale, NW9

£439 per week, £1,902 per month + fees

 2 Bedrooms  2 Bathrooms  Furnished

Stylish 2nd floor apartment set in a sought-after development in North West London. The property is conveniently located a short walk from Colindale Underground Station (Northern Line).

Please [click here](#) for full detail

Property features

Selection of Amenities nearby | Well Tended Communal Gardens | Private Balcony | Tastefully Furnished | Situated within TNQ development | EPC-B | Floor-to-ceiling windows | Concierge on-site | Secure allocated Parking | Nearby Colindale Tube Station

For more information about this property,
please call our Colindale branch on

020 8732 7980

Redress & Client Money Protection :

Benham and Reeves are members of The Property Ombudsman redress scheme and have Client Money protection with ARLA Propertymark. You can find more information on our website at <https://www.benham.com/membership/>



Benham & Reeves



Capitol Way, Colindale, NW9

£439 per week, £1,902 per month + fees

www.benhams.com

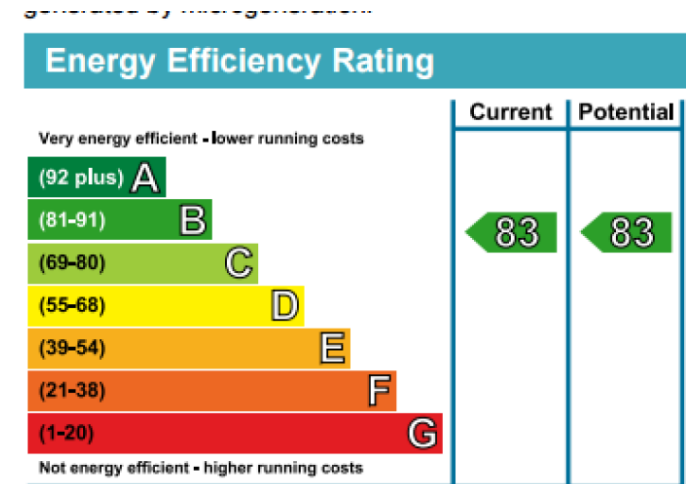
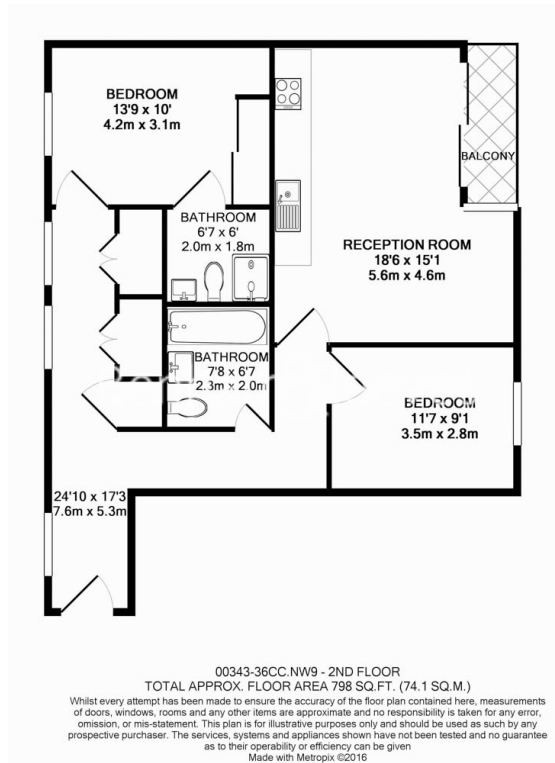

London branches open six days a week Mon - Sat

Canary Wharf | City | Colindale | Dartmouth Park | Ealing | Fulham
Hammersmith | Hampstead | Highgate | Hyde Park | Kensington | Kew
Knightsbridge | Nine Elms | Shoreditch | Southall | Surrey Quays
Wapping | Wembley | White City | Woolwich

International offices

China | Hong Kong SAR | India | Indonesia | Israel | Malaysia | Middle East | Pakistan
Qatar | Singapore | South Africa | Thailand | Turkey

