



Benham & Reeves

One Blackfriars Road, City, SE1

£2,539 per week, £11,002 per month + fees

 3 Bedrooms  4 Bathrooms  Furnished

Large three-bedroom apartment set within the highly prestigious One Blackfriars development on The Southbank. Located within a short walk of The City and easy reach of The West End and Canary Wharf

Please [click here](#) for full detail

Property features

Large three-bedroom luxury apartment | Three bespoke bathrooms and a guest WC | Underfloor heating & comfort cooling | Home automation - feature and mood lighting control | Wall mounted Sonos SoundBar system & flat screen TV | EPC-B | Residents pool and spa, gym, cinema and wine tasting room | Executive Lounge on 32nd floor with exceptional views | Dedicated 24h concierge | Moments from the Southbank, short walk to the City & close t

For more information about this property,
please call our City branch on

020 7213 9700

Redress & Client Money Protection :

Benham and Reeves are members of The Property Ombudsman redress scheme and have Client Money protection with ARLA Propertymark. You can find more information on our website at <https://www.benhamandreeves.com/membership/>



Benham & Reeves



One Blackfriars Road, City, SE1

£2,539 per week, £11,002 per month + fees

www.benhams.com

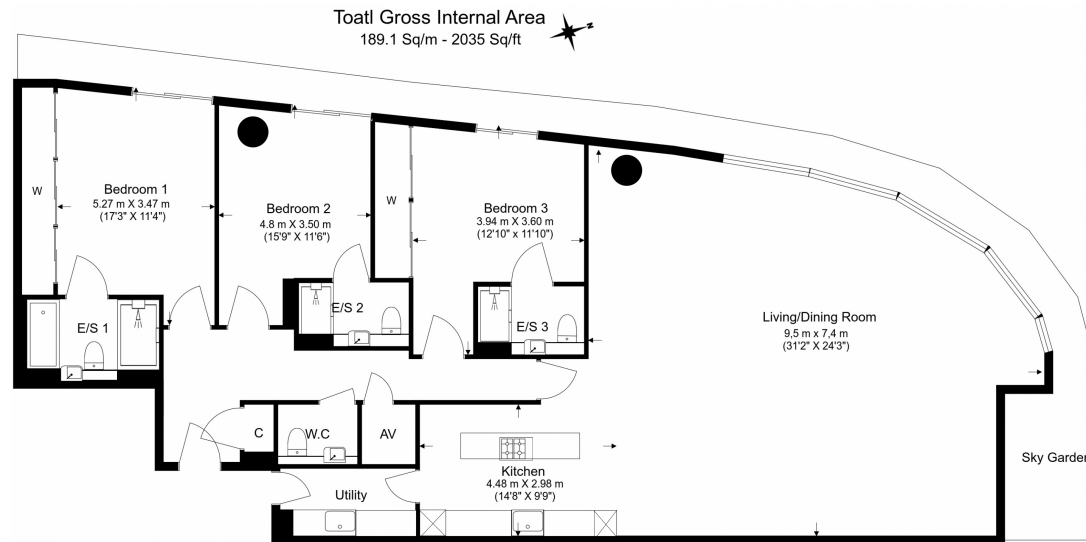

Floor Plan measurements are approximate and are for illustrative purposes only. While we do not doubt the floor plans accuracy, we make no guarantee, warranty or representation as to the accuracy and completeness of the floor plan.

London branches open six days a week Mon - Sat

Canary Wharf | City | Colindale | Dartmouth Park | Ealing | Fulham
Hammersmith | Hampstead | Highgate | Hyde Park | Kensington | Kew
Knightsbridge | Nine Elms | Shoreditch | Southall | Surrey Quays
Wapping | Wembley | White City | Woolwich

International offices

China | Hong Kong SAR | India | Indonesia | Qatar | Malaysia | Middle East | Pakistan
Singapore | South Africa | Thailand | Turkey



Benham & Reeves