



Benham & Reeves

Sloane Avenue Mansions, Chelsea, SW3

£655 per week, £2,838 per month + fees

 1 Bedroom  1 Bathroom  Furnished

A gorgeous 355 sq ft ONE-BEDROOM apartment located in Chelsea's popular SLOANE AVENUE MANSIONS. Residents benefit from a 24 Hr Porter & private BALCONY with incredible views.

The famous King's Road is a short walk, as are South Kensington & Sloane Square Stations. Rent includes Hot Water, Heating & Internet.

Please [click here](#) for full detail

Property features

1 Bedroom | 1 Bathroom | Balcony | Furnished | 24 Hr Concierge | EPC-C | 355 Sq Ft | Hot Water, Heating & Internet Included | Short Walk to the King's Road | South Kensington Underground Station

For more information about this property, please call our Knightsbridge branch on

020 7581 2112

Redress & Client Money Protection :

Benham and Reeves are members of The Property Ombudsman redress scheme and have Client Money protection with ARLA Propertymark. You can find more information on our website at <https://www.benhams.com/membership/>



Benham & Reeves



Sloane Avenue Mansions, Chelsea, SW3

£655 per week, £2,838 per month + fees

www.benhams.com

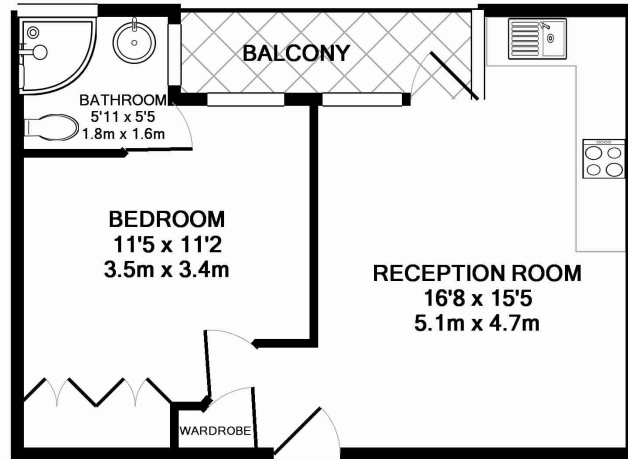

00252-H12 SAM.SW3 - 7TH FLOOR
TOTAL APPROX. FLOOR AREA 348 SQ.FT. (32.3 SQ.M.)

Whilst every attempt has been made to ensure the accuracy of the floor plan contained here, measurements of doors, windows, rooms and any other items are approximate and no responsibility is taken for any error, omission, or mis-statement. This plan is for illustrative purposes only and should be used as such by any prospective purchaser. The services, systems and appliances shown have not been tested and no guarantee as to their operability or efficiency can be given
Made with Metropix ©2015



| Energy Efficiency Rating | | |
|--|----------------------------|-----------|
| | Current | Potential |
| <i>Very energy efficient - lower running costs</i> | | |
| (92 plus) A | | |
| (81-91) B | | |
| (69-80) C | 73 | 74 |
| (55-68) D | | |
| (39-54) E | | |
| (21-38) F | | |
| (1-20) G | | |
| <i>Not energy efficient - higher running costs</i> | | |
| England & Wales | EU Directive 2002/91/EC | |

London branches open six days a week Mon - Sat

Canary Wharf | City | Colindale | Dartmouth Park | Ealing | Fulham
Hammersmith | Hampstead | Highgate | Hyde Park | Kensington | Kew
Knightsbridge | Nine Elms | Shoreditch | Southall | Surrey Quays
Wapping | Wembley | White City | Woolwich



International offices

China | Hong Kong SAR | India | Indonesia | Qatar | Malaysia | Middle East | Pakistan
Singapore | South Africa | Thailand | Turkey

Benham & Reeves