



Benham & Reeves

## Chelsea Manor Court, Chelsea, SW3

£875 per week, £3,792 per month + fees

 3 Bedrooms    3 Bathrooms    Furnished

A well-presented 751 sq ft THREE-BEDROOM DUPLEX apartment with PRIVATE TERRACE in an immaculately-maintained development on Chelsea's MANOR STREET just moments from the KINGS ROAD in the heart of CHELSEA.

Please [click here](#) for full detail

## Property features

**Separate Fitted Kitchen | Furnished | Ample Storage | Dark Wood Flooring Throughout | Duplex Apartment | EPC-C | 751 Sq Ft | Patio | Close To Shops And Restaurants | Walking Distance To Sloane Square Station**

For more information about this property, please call our Knightsbridge branch on

**020 7581 2112**

Redress & Client Money Protection :

Benham and Reeves are members of The Property Ombudsman redress scheme and have Client Money protection with ARLA Propertymark. You can find more information on our website at <https://www.benhams.com/membership/>



Benham & Reeves



# Chelsea Manor Court, Chelsea, SW3

£875 per week, £3,792 per month + fees

www.benhams.com

Chelsea Manor Court  
Approx. Gross Internal Area 827 Sq Ft - 76.83 Sq M

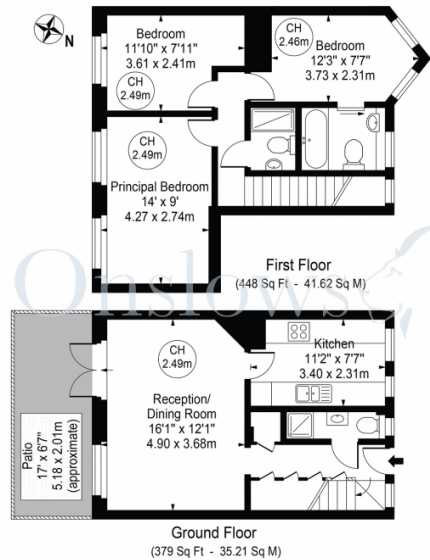

For Illustration Purposes Only - Not To Scale  
This floor plan should be used as a general outline for guidance only and does not constitute in whole or in part an offer or contract. Any intending purchaser or lessee should satisfy themselves by inspection, searches, enquiries and full survey as to the correctness of each statement. Any areas, measurements or distances quoted are approximate and should not be used to value a property or be the basis of any sale or let. Copyright Montari Photography & Design LTD.

| Score | Energy rating | Current | Potential |
|-------|---------------|---------|-----------|
| 92+   | A             |         |           |
| 81-91 | B             |         |           |
| 69-80 | C             | 71   c  | 75   c    |
| 55-68 | D             |         |           |
| 39-54 | E             |         |           |
| 21-38 | F             |         |           |
| 1-20  | G             |         |           |

## London branches open six days a week Mon - Sat

Canary Wharf | City | Colindale | Dartmouth Park | Ealing | Fulham  
Hammersmith | Hampstead | Highgate | Hyde Park | Kensington | Kew  
Knightsbridge | Nine Elms | Shoreditch | Southall | Surrey Quays  
Wapping | Wembley | White City | Woolwich

## International offices

China | Hong Kong SAR | India | Indonesia | Qatar | Malaysia | Middle East | Pakistan  
Singapore | South Africa | Thailand | Turkey

