



Benham & Reeves

Grosvenor Waterside, Chelsea Embankment, SW1W

£1,100 per week, £4,767 per month + fees

 2 Bedrooms  2 Bathrooms  Furnished

An exceptional 947 sq ft TWO-BEDROOM apartment with private BALCONY in the popular GROSVENOR WATERSIDE development where residents enjoy 24 Hr Concierge, a luxury Health Club and on-site Sainsbury's market & Coffee Shop.

Please [click here](#) for full detail

Property features

Large Corner Unit | Private Balcony | 24 Hr Concierge | Fitness Suite & Spa | Secure Parking | EPC-C | 915 Sq Ft | On Site Cafe | On Site Sainsburys | Sloane Square Station and Victoria Station

For more information about this property, please call our Knightsbridge branch on

020 7581 2112

Redress & Client Money Protection :

Benham and Reeves are members of The Property Ombudsman redress scheme and have Client Money protection with ARLA Propertymark. You can find more information on our website at <https://www.benhams.com/membership/>



Benham & Reeves



Grosvenor Waterside, Chelsea Embankment, SW1W

www.benhams.com

£1,100 per week, £4,767 per month + fees

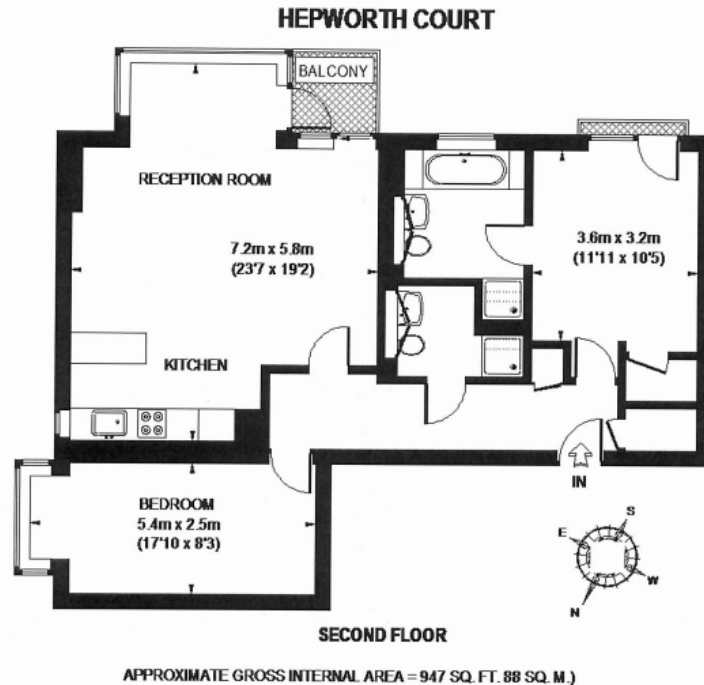

Score	Energy rating	Current	Potential
92+	A		
81-91	B		
69-80	C	70 c	70 c
55-68	D		
39-54	E		
21-38	F		
1-20	G		

London branches open six days a week Mon - Sat

Canary Wharf | City | Colindale | Dartmouth Park | Ealing | Fulham
Hammersmith | Hampstead | Highgate | Hyde Park | Kensington | Kew
Knightsbridge | Nine Elms | Shoreditch | Southall | Surrey Quays
Wapping | Wembley | White City | Woolwich



International offices

China | Hong Kong SAR | India | Indonesia | Qatar | Malaysia | Middle East | Pakistan
Singapore | South Africa | Thailand | Turkey

Benham & Reeves