



Benham & Reeves

Fairthorn Road, Charlton, SE7

£438 per week, £1,900 per month + fees

 2 Bedrooms  2 Bathrooms  Furnished

A modern spacious 3rd floor apartment situated in a modern development in Charlton, SE7. The property is offered furnished and is located nearby Westcombe Park National Rail station.

Please [click here](#) for full detail

Property features

2 Bedrooms | 2 Bathrooms | Open Planned Reception | Furnished | Fitted Kitchen | EPC-B | Ideal for Sharers | Balcony | Nearby Westcombe Park BR Station

For more information about this property, please call our Woolwich branch on

020 8051 0700

Redress & Client Money Protection :

Benham and Reeves are members of The Property Ombudsman redress scheme and have Client Money protection with ARLA Propertymark. You can find more information on our website at <https://www.benhams.com/membership/>



Benham & Reeves



Fairthorn Road, Charlton, SE7

£438 per week, £1,900 per month + fees

www.benhams.com

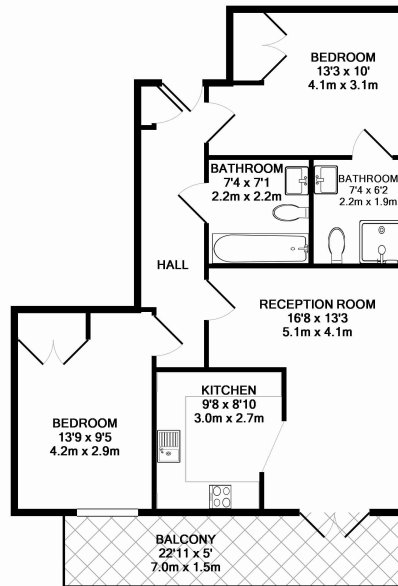

00384-23VW.84FR.SE7 - 3RD FLOOR
 TOTAL APPROX. FLOOR AREA 695 SQ.FT. (64.6 SQ.M.)
 Whilst every attempt has been made to ensure the accuracy of the floor plan contained here, measurements of doors, windows, rooms and any other items are approximate and no responsibility is taken for any error, omission, or mis-statement. This plan is for illustrative purposes only and should be used as such by any prospective purchaser. The services, systems and appliances shown have not been tested and no guarantee as to their operability or efficiency can be given.
 Made with Metropix 62015

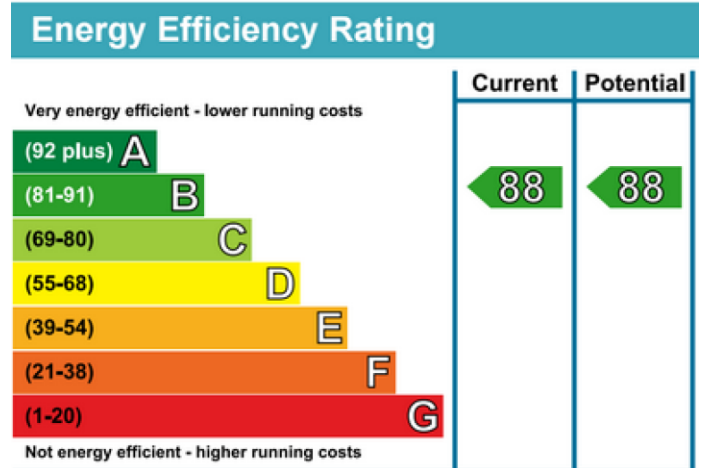

London branches open six days a week Mon - Sat

Canary Wharf | City | Colindale | Dartmouth Park | Ealing | Fulham
 Hammersmith | Hampstead | Highgate | Hyde Park | Kensington | Kew
 Knightsbridge | Nine Elms | Shoreditch | Southall | Surrey Quays
 Wapping | Wembley | White City | Woolwich

International offices

China | Hong Kong SAR | India | Indonesia | Qatar | Malaysia | Middle East | Pakistan
 Singapore | South Africa | Thailand | Turkey

