



Benham & Reeves

White City Living, Cascade Apartments, Cascade Way, White City W12

£923 per week, £4,000 per month + fees

 2 Bedrooms  2 Bathrooms  Furnished

An impeccable 2 bedroom apartment set in White City Living within the heart of Shepherd's Bush. The property is located close to the Westfield Shopping Centre and 2-minutes' walk from White City & Wood Lane underground stations. EPC-B

Please [click here](#) for full detail

Property features

2 Bedroom Apartment with Built-in Wardrobe (11th Floor with | Open plan Reception Room with Dining Area & Floor to Ceiling | Fully Fitted Kitchen Integrated with well-known Appliances | 2 x Luxurious Double Bathroom with Large Mirrors and Ample | Internal Area: 793 Sq Ft / EPC-B / Utility Room / Hallway | EPC-B | Quality Furnished / LED Spotlights / Private Balcony (78 Sq | Air Ventilation / Underfloor Heating / Air Conditioning | Residents' Swimming Pool, Gym, Meeting Room, Resident's Loun | White City & Wood Lane Underground Stations

For more information about this property, please call our White City branch on

020 8187 0888

Redress & Client Money Protection :

Benham and Reeves are members of The Property Ombudsman redress scheme and have Client Money protection with ARLA Propertymark. You can find more information on our website at <https://www.benham.com/membership/>

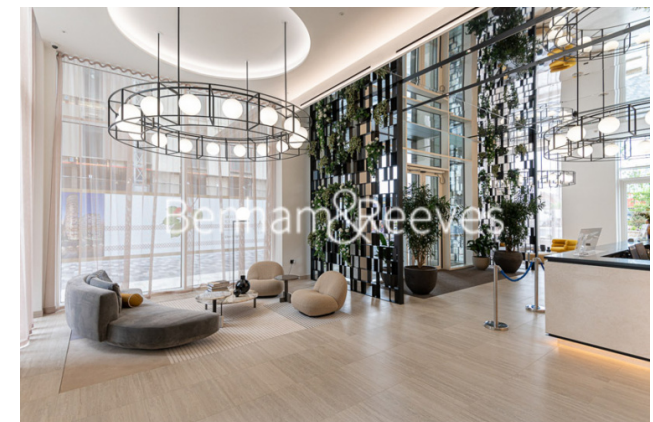
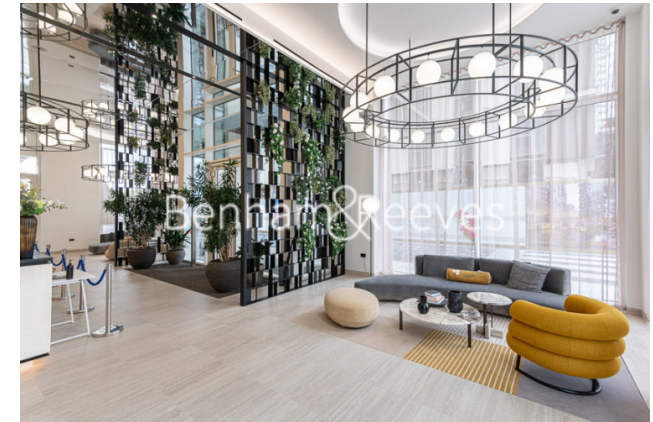

Benham & Reeves

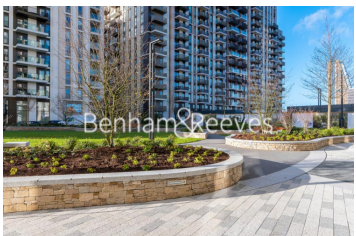
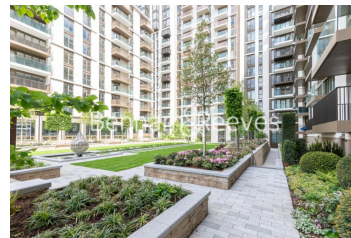
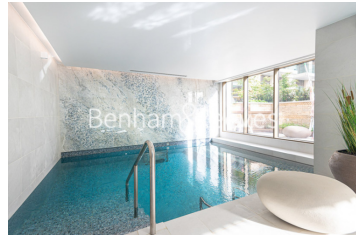
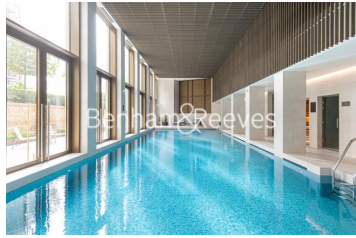

White City Living, Cascade Apartments, Cascade Way, White City W12

www.benhams.com

£923 per week, £4,000 per month + fees

TWO BEDROOM



Internal area	73.7 m ²	793 sq ft
External area	7.9 m ²	78 sq ft
Kitchen	3.03 x 2.86 m	10'0" x 9'5" 1/2"
Living/Dining	3.33 x 4.67 m	10'11" x 15'4"
Bedroom 1	4.20 x 2.96 m	13'9" x 9'8"
Bedroom 2	2.82 x 2.75 m	9'3" x 9'1" 1/2"
Balcony	4.86 x 1.65 m	16'0" x 5'5" 1/2"

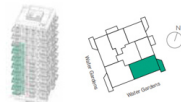

© Coal Casbard U Shy Casbard W Wierliche WED Washer Dryer S Shining WM Washing Machine x Distance Indicator TD Tumble Dryer
Floorplan shown for White City Living only for approximate measurements only. Exact layout and areas may vary. All measurements may vary within a tolerance of 1%. To increase legibility these plans have been scaled to fit the page. Dimensions include main walls and different walls to others unless otherwise stated. The dimensions are not intended to be used for contract work, applications for planning or building. Kitchen appliances and positions indicated are for guidance only. External loading and window location and sizing are indicative and subject to change. Fixtures and fittings dependent on apartment location. Accuracy dimensions may be subject to change.

Score	Energy rating	Current	Potential
92+	A		
81-91	B	87 B	87 B
69-80	C		
55-68	D		
39-54	E		
21-38	F		
1-20	G		

London branches open six days a week Mon - Sat

Canary Wharf | City | Colindale | Dartmouth Park | Ealing | Fulham
Hammersmith | Hampstead | Highgate | Hyde Park | Kensington | Kew
Knightsbridge | Nine Elms | Shoreditch | Southall | Surrey Quays
Wapping | Wembley | White City | Woolwich

International offices

China | Hong Kong SAR | India | Indonesia | Qatar | Malaysia | Middle East | Pakistan
Singapore | South Africa | Thailand | Turkey

