



Benham & Reeves

Crossharbour Plaza, Canary Wharf, E14

£727 per week, £3,150 per month + fees

🛏️ 2 Bedrooms 🚿 2 Bathrooms 🛋️ Furnished

MDOERN , two-bedroom apartment in Arena Tower that is designed with PURE LUXURY in mind. The property is well-appointed with FURNISHINGS, private BALCONY. The AMENITIES offer the discerning resident a prestigious lifestyle.

Please [click here](#) for full detail

Property features

Two Double Bedrooms | Two Bathrooms | Furnished | Open Plan Living | Fitted Kitchen | EPC-B | Gym and Swimming Pool | Private Balcony | Nearby South Quay DLR

For more information about this property,
please call our Canary Wharf branch on

020 8036 3200

Redress & Client Money Protection :

Benham and Reeves are members of The Property Ombudsman redress scheme and have Client Money protection with ARLA Propertymark. You can find more information on our website at <https://www.benhams.com/membership/>



Benham & Reeves

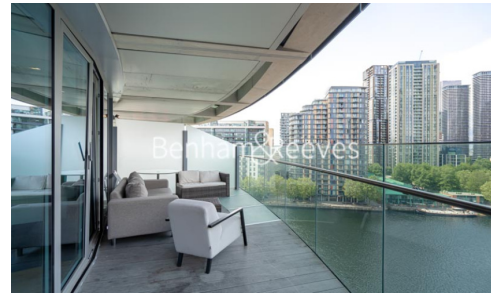

Crossharbour Plaza, Canary Wharf, E14

£727 per week, £3,150 per month + fees

www.benhams.com

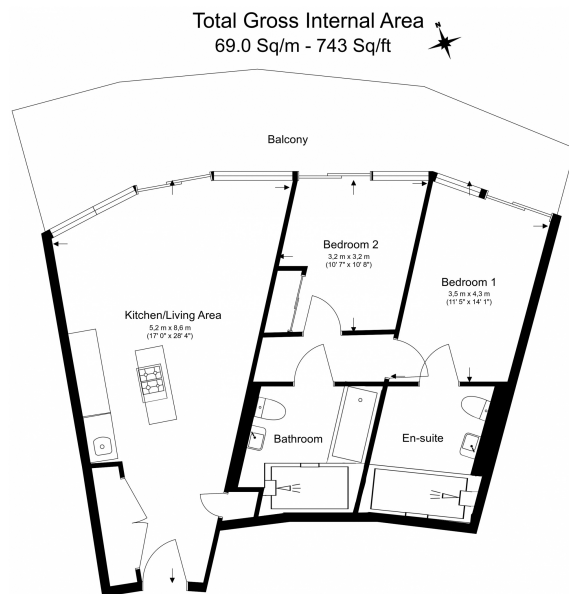

Floor Plan measurements are approximate and are for illustrative purposes only. While we do not doubt the floor plans accuracy, we make no guarantee, warranty or representation as to the accuracy and completeness of the floor plan.

Score	Energy rating	Current	Potential
92+	A		
81-91	B	82 B	82 B
69-80	C		
55-68	D		
39-54	E		
21-38	F		
1-20	G		

London branches open six days a week Mon - Sat

Canary Wharf | City | Colindale | Dartmouth Park | Ealing | Fulham
Hammersmith | Hampstead | Highgate | Hyde Park | Kensington | Kew
Knightsbridge | Nine Elms | Shoreditch | Southall | Surrey Quays
Wapping | Wembley | White City | Woolwich

International offices

China | Hong Kong SAR | India | Indonesia | Qatar | Malaysia | Middle East | Pakistan
Singapore | South Africa | Thailand | Turkey



Benham & Reeves