



Benham & Reeves

Mellor House, Canary Wharf, E14

£450 per week, £1,950 per month + fees

 1 Bedroom  1 Bathroom  Furnished

Beautifully presented 4th floor apartment located in the sought-after New Festival Quarter development. Well-located for All Saints DLR with direct trains to Canary Wharf.

Please [click here](#) for full detail

Property features

One Double Bedroom | Family Sized Bathroom | Open Planned Living Space | Fitted Kitchen | Furnished | EPC-B | Resident Gym | 24 Hour Concierge | Private Balcony | Langdon Park DLR Station Nearby

For more information about this property,
please call our Canary Wharf branch on

020 8036 3200

Redress & Client Money Protection :

Benham and Reeves are members of The Property Ombudsman redress scheme and have Client Money protection with ARLA Propertymark. You can find more information on our website at <https://www.benhams.com/membership/>



Benham & Reeves



Mellor House, Canary Wharf, E14

£450 per week, £1,950 per month + fees

www.benhams.com

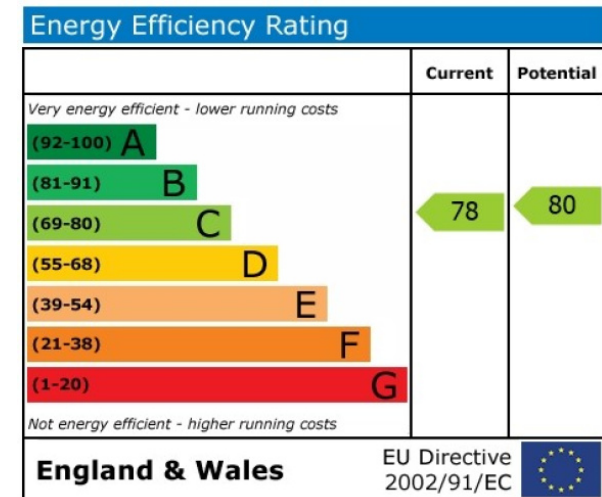
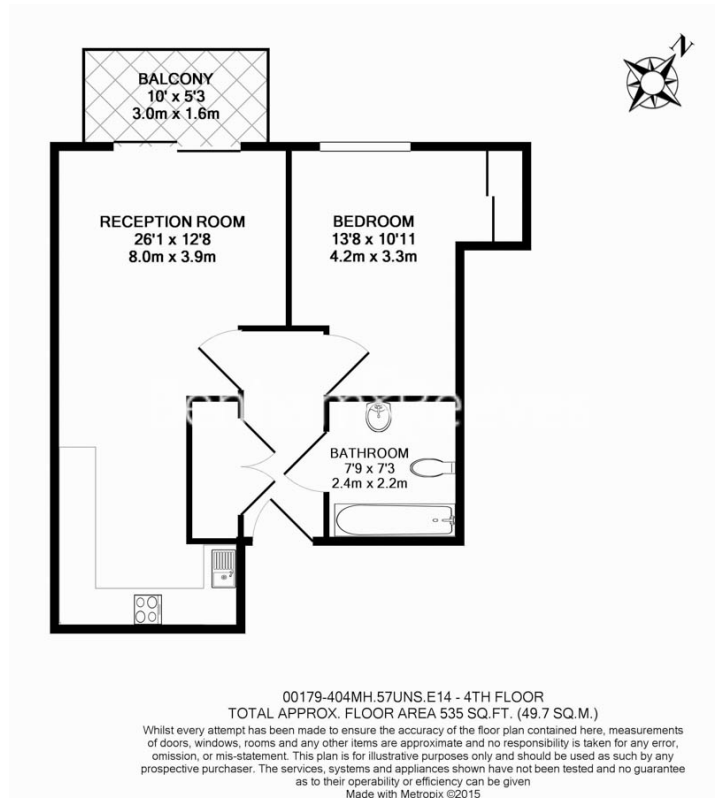

London branches open six days a week Mon - Sat

Canary Wharf | City | Colindale | Dartmouth Park | Ealing | Fulham
Hammersmith | Hampstead | Highgate | Hyde Park | Kensington | Kew
Knightsbridge | Nine Elms | Shoreditch | Southall | Surrey Quays
Wapping | Wembley | White City | Woolwich

International offices

China | Hong Kong SAR | India | Indonesia | Qatar | Malaysia | Middle East | Pakistan
Singapore | South Africa | Thailand | Turkey



Benham & Reeves