



Benham & Reeves

Benham & Reeves

Millharbour, Canary Wharf ,E14

£473 per week, £2,050 per month + fees

🛏️ 1 Bedroom 🚿 1 Bathroom 🚗 Furnished

Bright, modern apartment with good resident onsite amenities within a thriving development well located for South Quay DLR Station and Canary Wharf Station.

Please [click here](#) for full detail

Property features

One Double Bedroom | One Bathroom | Open Planned Living Space | Furnished | Fitted Kitchen | EPC-B | 24 Hour Concierge | Residence Gym | Nearby South Quay DLR station

For more information about this property, please call our Canary Wharf branch on

020 8036 3200

Redress & Client Money Protection :

Benham and Reeves are members of The Property Ombudsman redress scheme and have Client Money protection with ARLA Propertymark. You can find more information on our website at <https://www.benhams.com/membership/>



Benham & Reeves



Millharbour, Canary Wharf ,E14

£473 per week, £2,050 per month + fees

www.benhams.com

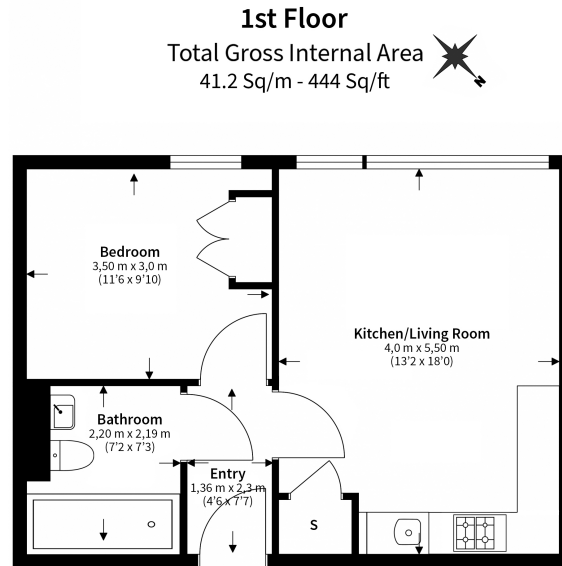

Floor Plan measurements are approximate and are for illustrative purposes only. While we do not doubt the floor plans accuracy, we make no guarantee, warranty or representation as to the accuracy and completeness of the floor plan.

[See how to improve this property's energy efficiency.](#)

Score	Energy rating	Current	Potential
92+	A		
81-91	B	81 B	83 B
69-80	C		
55-68	D		
39-54	E		
21-38	F		
1-20	G		

London branches open six days a week Mon - Sat

Canary Wharf | City | Colindale | Dartmouth Park | Ealing | Fulham
Hammersmith | Hampstead | Highgate | Hyde Park | Kensington | Kew
Knightsbridge | Nine Elms | Shoreditch | Southall | Surrey Quays
Wapping | Wembley | White City | Woolwich

International offices

China | Hong Kong SAR | India | Indonesia | Qatar | Malaysia | Middle East | Pakistan
Singapore | South Africa | Thailand | Turkey



Benham & Reeves