



Benham&Reeves

Naxos Building, Canary Wharf, E14

£462 per week, £2,002 per month + fees

🛏 1 Bedroom 🚿 1 Bathroom 🛋 Furnished

A stylish 9th floor apartment with direct River views of the River ideally located for access to Canary Wharf and the City.

Please [click here](#) for full detail

Property features

1 Double Bedroom | 1 Bathroom | Reception | Furnished | Fitted Kitchen | EPC-C | 24 Hour Concierge | Parking Space | Nearby South Quay DLR Station

For more information about this property,
please call our Canary Wharf branch on

020 8036 3200



Redress & Client Money Protection :
Benham and Reeves are members of The Property Ombudsman redress scheme and have Client Money protection with ARLA Propertymark.
You can find more information on our website at <https://www.benhams.com/membership/>

Benham&Reeves



Naxos Building, Canary Wharf, E14

£462 per week, £2,002 per month + fees

www.benhams.com

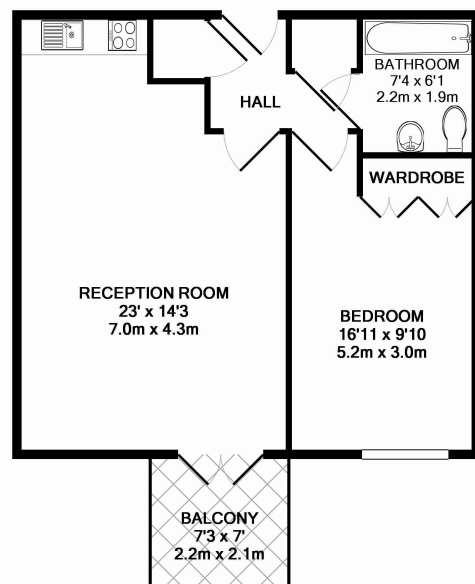

NAXOS BUILDING, 4 HUTCHING STREET, E14
TOTAL APPROX. FLOOR AREA 555 SQ.FT. (51.6 SQ.M.)

Whilst every attempt has been made to ensure the accuracy of the floor plan contained here, measurements of doors, windows, rooms and any other items are approximate and no responsibility is taken for any error, omission, or mis-statement. This plan is for illustrative purposes only and should be used as such by any prospective purchaser. The services, systems and appliances shown have not been tested and no guarantee as to their operability or efficiency can be given.
Made with Metropix ©2014

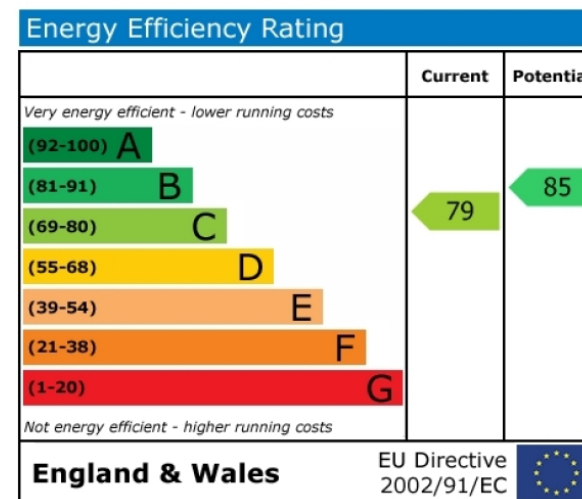

London branches open six days a week Mon - Sat

Canary Wharf | City | Colindale | Dartmouth Park | Ealing | Fulham
Hammersmith | Hampstead | Highgate | Hyde Park | Kensington | Kew
Knightsbridge | Nine Elms | Shoreditch | Southall | Surrey Quays
Wapping | Wembley | White City | Woolwich

International offices

China | Hong Kong SAR | India | Indonesia | Qatar | Malaysia | Middle East | Pakistan
Singapore | South Africa | Thailand | Turkey



Benham & Reeves