



Benham & Reeves

Theobalds Road, Bloomsbury, WC1

£923 per week, £4,000 per month + fees

 2 Bedrooms  2 Bathrooms  Furnished

Large and contemporary apartment situated within a period building conversion on Theobalds Road, close to Chancery Lane, Holborn and Bloomsbury.

Please [click here](#) for full detail

Property features

Two Bedrooms | Two Bathrooms | Open Plan Reception | Furnished | Designer Kitchen | EPC-B | Wood Floors | Floor To Ceiling Windows | 827 Sq Ft | Nearby Holborn Tube Station

For more information about this property, please call our City branch on

020 7213 9700

Redress & Client Money Protection :

Benham and Reeves are members of The Property Ombudsman redress scheme and have Client Money protection with ARLA Propertymark. You can find more information on our website at <https://www.benhams.com/membership/>



Benham&Reeves



Theobalds Road, Bloomsbury, WC1

£923 per week, £4,000 per month + fees

www.benhams.com

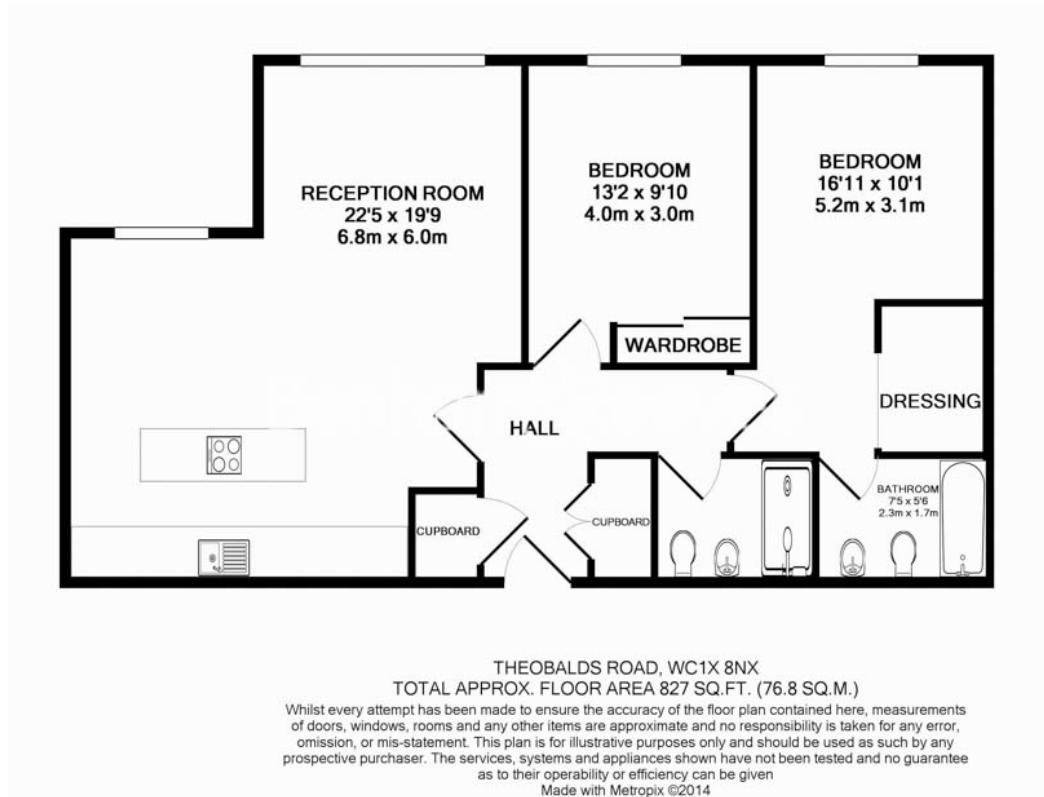

Energy Efficiency Rating		
	Current	Potential
Very energy efficient - lower running costs		
(92 plus) A		
(81-91) B	87	87
(69-80) C		
(55-68) D		
(39-54) E		
(21-38) F		
(1-20) G		
Not energy efficient - higher running costs		
England & Wales	EU Directive 2002/91/EC	

London branches open six days a week Mon - Sat

Canary Wharf | City | Colindale | Dartmouth Park | Ealing | Fulham
 Hammersmith | Hampstead | Highgate | Hyde Park | Kensington | Kew
 Knightsbridge | Nine Elms | Shoreditch | Southall | Surrey Quays
 Wapping | Wembley | White City | Woolwich

International offices

China | Hong Kong SAR | India | Indonesia | Qatar | Malaysia | Middle East | Pakistan
 Singapore | South Africa | Thailand | Turkey

