



Benham & Reeves

Maltby Street, Bermondsey, SE1

£554 per week, £2,401 per month + fees

 1 Bedroom  1 Bathroom  Furnished

Unique 7th floor apartment, with large roof terrace, set in an uber cool neighbourhood moment from Tower Bridge. Ideally located for Bermondsey Underground Station (Jubilee Line) and short walking distance to London Bridge and The City.

Please [click here](#) for full detail

Property features

One Double Bedroom | One Bathroom | Open Plan Reception | Furnished | Integrated Kitchen Appliances | EPC-B | Close To London Bridge & The City | Private Balcony | Short walk to London Bridge Station

For more information about this property, please call our Surrey Quays branch on

020 7740 3050

Redress & Client Money Protection :

Benham and Reeves are members of The Property Ombudsman redress scheme and have Client Money protection with ARLA Propertymark. You can find more information on our website at <https://www.benhams.com/membership/>



Benham & Reeves



Maltby Street, Bermondsey, SE1

£554 per week, £2,401 per month + fees

www.benhams.com

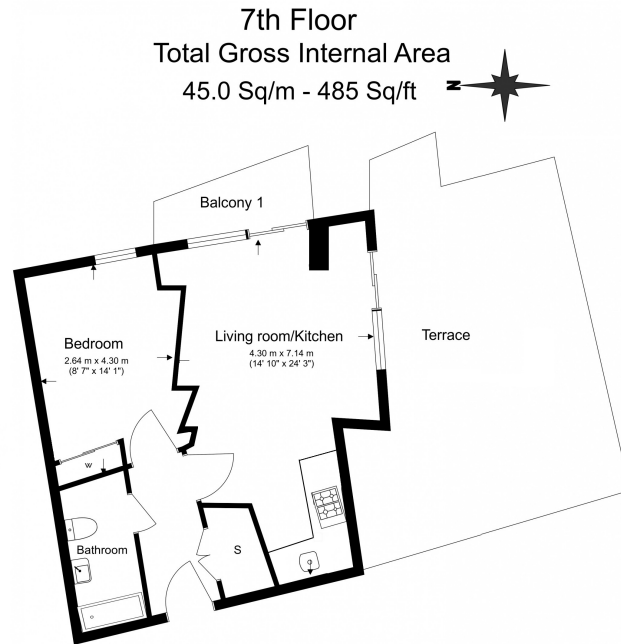

Floor Plan measurements are approximate and are for illustrative purposes only. While we do not doubt the floor plans accuracy, we make no guarantee, warranty or representation as to the accuracy and completeness of the floor plan.

Energy Efficiency Rating

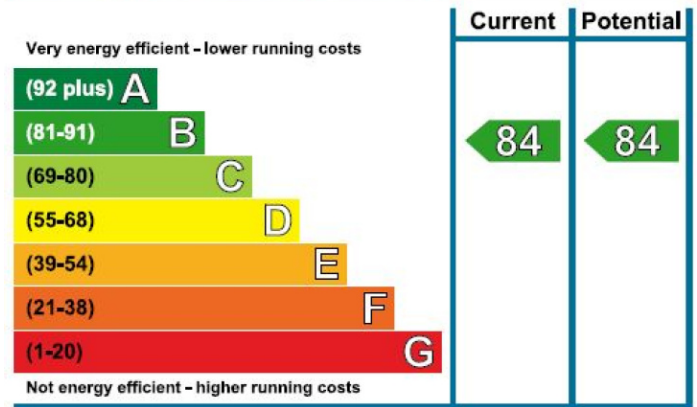

London branches open six days a week Mon - Sat

Canary Wharf | City | Colindale | Dartmouth Park | Ealing | Fulham
Hammersmith | Hampstead | Highgate | Hyde Park | Kensington | Kew
Knightsbridge | Nine Elms | Shoreditch | Southall | Surrey Quays
Wapping | Wembley | White City | Woolwich

International offices

China | Hong Kong SAR | India | Indonesia | Israel | Malaysia | Middle East | Pakistan
Qatar | Singapore | South Africa | Thailand | Turkey

