



Benham & Reeves

**Tarnbrook Court, Belgravia, SW1W**

£3,750 per week, £16,250 per month + fees

 3 Bedrooms    3 Bathrooms    Furnished

A stunning 2,036 sq ft THREE-BEDROOM luxury PENTHOUSE apartment on the borders of BELGRAVIA & CHELSEA with private lift access & terrace situated in TARNBROOK COURT within 3 minutes of SLOANE SQUARE.

Please [click here](#) for full detail

## Property features

**Penthouse | Prime Belgravia/Chelsea Location | Furnished | 2,036 sq ft | Private Lift & Terrace | EPC-C | Rooftop Views | Resident Porter | Secure Alarm System | Sloane Square Station**

For more information about this property, please call our Knightsbridge branch on

**020 7581 2112**

Redress & Client Money Protection :

Benham and Reeves are members of The Property Ombudsman redress scheme and have Client Money protection with ARLA Propertymark. You can find more information on our website at <https://www.benhams.com/membership/>



Benham & Reeves





# Tarnbrook Court, Belgravia, SW1W

£3,750 per week, £16,250 per month + fees

www.benhams.com

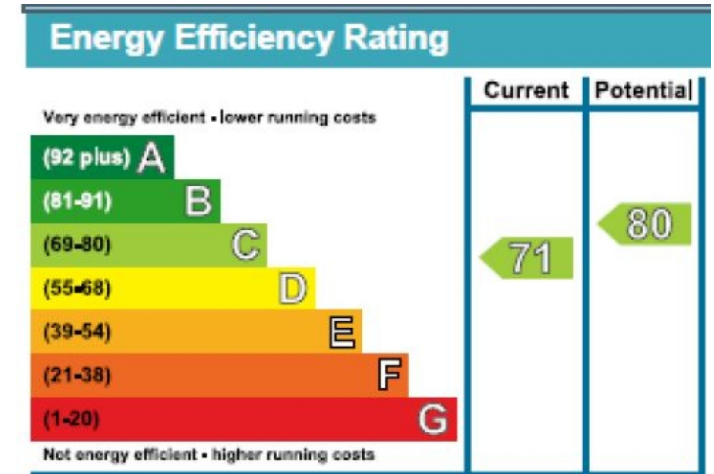
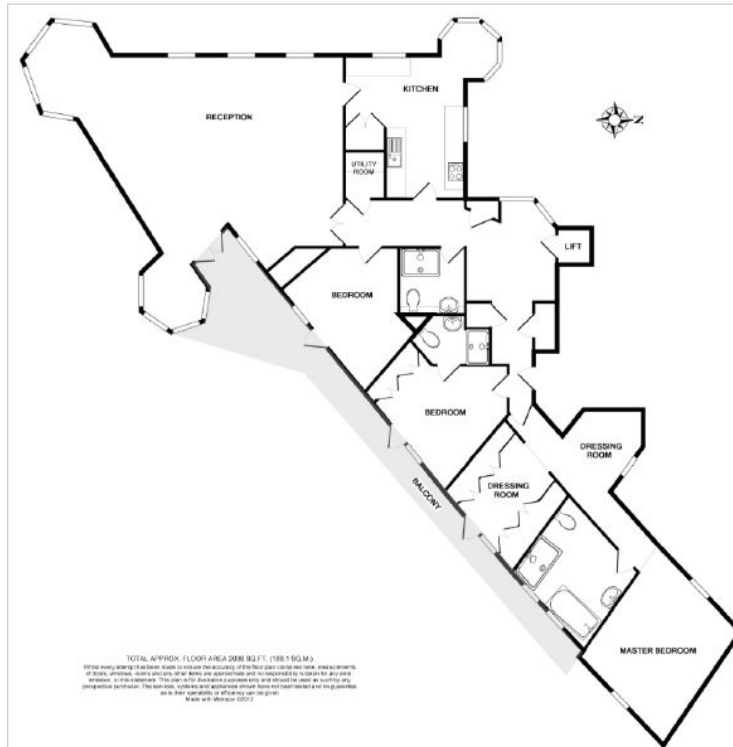

## London branches open six days a week Mon - Sat

Canary Wharf | City | Colindale | Dartmouth Park | Ealing | Fulham  
 Hammersmith | Hampstead | Highgate | Hyde Park | Kensington | Kew  
 Knightsbridge | Nine Elms | Shoreditch | Southall | Surrey Quays  
 Wapping | Wembley | White City | Woolwich

## International offices

China | Hong Kong SAR | India | Indonesia | Qatar | Malaysia | Middle East | Pakistan  
 Singapore | South Africa | Thailand | Turkey

