



Benham & Reeves

**Fladgate House, Battersea, SW11**

£969 per week, £4,200 per month + fees

 2 Bedrooms    2 Bathrooms    Furnished

Stunning 13th floor apartment situated within a sought after development with wonderful River views and 5\* residents' facilities. Positioned perfectly for Battersea Power Station tube station ( Northern Line).

Please [click here](#) for full detail

## Property features

**Two double bedrooms | Two bathrooms | Balcony | Direct views of Battersea Power Station | Air cooling | EPC-B | 24 Hour concierge | Swimming pool | Gym | Battersea Power Station tube**

For more information about this property, please call our Nine Elms branch on

**020 3282 3700**

Redress & Client Money Protection :

Benham and Reeves are members of The Property Ombudsman redress scheme and have Client Money protection with ARLA Propertymark. You can find more information on our website at <https://www.benhams.com/membership/>



Benham & Reeves







# Fladgate House, Battersea, SW11

£969 per week, £4,200 per month + fees

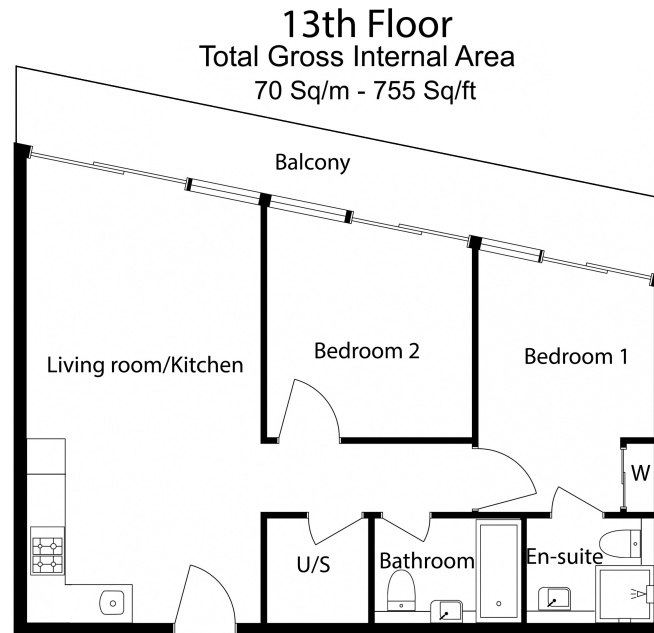
www.benhams.com



| Energy Efficiency Rating                           |   |           |
|--|---|-----------|
|  | Current   | Potential |
| <i>Very energy efficient - lower running costs</i> |   |           |
| (92-100) <b>A</b>                                  |   |           |
| (81-91) <b>B</b>                                   |   |           |
| (69-80) <b>C</b>                                   | 76  | 76        |
| (55-68) <b>D</b>                                   |   |           |
| (39-54) <b>E</b>                                   |   |           |
| (21-38) <b>F</b>                                   |   |           |
| (1-20) <b>G</b>                                    |   |           |
| <i>Not energy efficient - higher running costs</i> |   |           |
| <b>England &amp; Wales</b>                         | EU Directive 2002/91/EC  |           |

**Benham & Reeves**

Floor Plan measurements are approximate and are for illustrative purposes only. While we do not doubt the floor plans accuracy, we make no guarantee, warranty or representation as to the accuracy and completeness of the floor plan.

## London branches open six days a week Mon - Sat

Canary Wharf | City | Colindale | Dartmouth Park | Ealing | Fulham  
Hammersmith | Hampstead | Highgate | Hyde Park | Kensington | Kew  
Knightsbridge | Nine Elms | Shoreditch | Southall | Surrey Quays  
Wapping | Wembley | White City | Woolwich

## International offices

China | Hong Kong SAR | India | Indonesia | Qatar | Malaysia | Middle East | Pakistan  
Singapore | South Africa | Thailand | Turkey



**Benham & Reeves**