



Chilworth Mews, Paddington, W2

Asking Price: £750,000

Benham
& Reeves

Chilworth Mews, Paddington, W2

🏠 2 Bedroom (s) 🚿 2 Bathroom (s) 🔑 Leasehold

Modern and sleek two bedroom, two bathroom apartment located on the second floor of Chilworth Mews. Spanning an approximate 721 square feet, this apartment comprises an open-plan reception room with wooden flooring, dining space and a fully fitted modern kitchen with integrated appliances and white-gloss cabinets. There are two double bedrooms with ample storage space, an en-suite shower room to the main bedroom, family bathroom with chrome fixtures and fittings and large mirrored cabinets and a good size hallway area. The apartment is neutrally decorated.

Chilworth Mews is moments from the shops, restaurants, cafes and bars of popular W2 areas such as Paddington, Bayswater and Queensway. The open spaces of Hyde Park and the amenities of the West End are a short journey away.

The development is ideally located a short walk from Paddington (Bakerloo, District, Circle and Hammersmith & City lines) underground station, as well as Paddington National Rail station, which offers the Heathrow Express.





Property Features:

- Two Bedrooms
- Two Bathrooms
- Second Floor
- 721 Square Feet (Approx.)
- Open Plan Living Area
- Fully Fitted Sleek Kitchen
- Modern and Spacious
- Close To Local Amenities
- Moments From Bayswater and Queensway
- Paddington Station (Zone 1)



Gross Internal Area: 67 sq/m - 721 sq/ft

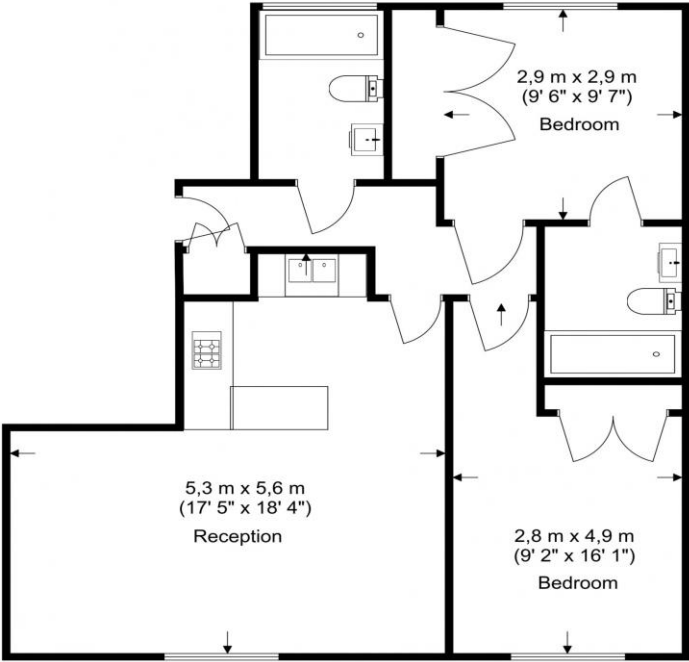

Floor Plan measurements are approximate and are for illustrative purposes only. While we do not doubt the floor plans accuracy, we make no guarantee, warranty or representation as to the accuracy and completeness of the floor plan.

Energy Efficiency Rating		
	Current	Potential
<i>Very energy efficient - lower running costs</i>		
(92+) A		
(81-91) B		
(69-80) C	79	83
(55-68) D		
(39-54) E		
(21-38) F		
(1-20) G		
<i>Not energy efficient - higher running costs</i>		
England, Scotland & Wales	EU Directive 2002/91/EC	

Terms & Conditions:

These particulars are for guidance purposes only and do not form part of an offer or contract.

Asking Price:	£750,000
Tenure:	Leasehold Expires 31/12/3009 Approximately 984 Years Remaining
Ground Rent:	Not applicable
Service Charge:	£3,603.00 (per annum) To March 2025
Anticipated Rent:	£2,645.00 pcm Approx. 4.2% Yield

Viewings:

All viewings are by appointment only through our Kensington Office.

Our reference: KEN240233

T: 020 7938 3522

E: kensington.sales@benhams.com

W: www.benhams.com

Disclaimer: These particulars are for guidance purposes only and do not form part of an offer or contract. Whilst care has been taken in their preparation, Benham and Reeves or the vendor shall not be held responsible for any inaccuracies. You should not rely on statements by Benham and Reeves Ltd in the particulars or by word of mouth or in writing as being factually accurate about the property, its condition or its value. Any areas, measurements or distances are approximate. The text, photographs and plans are for guidance only. The photographs appearing in these particulars show only certain parts of the property at the time when the photographs were taken. It should not be assumed that the property has all or any of the necessary planning permission, building regulation consent approval or other required consents for its previous, present or future intended usage. Any intending purchasers must satisfy themselves by inspection or by taking appropriate professional advice. Benham and Reeves Ltd has not rested any of the equipment, fittings or facilities.

London | Canary Wharf | City | Colindale | Dartmouth Park | Ealing | Fulham | Hampstead
Hammersmith | Highgate | Hyde Park | Kensington | Kew | Knightsbridge | Nine Elms
Surrey Quays | Shoreditch | Wembley | Wapping | White City | Woolwich

International | China | Hong Kong | India | Israel | Malaysia | Middle East | Pakistan
Singapore | South Africa | Turkey

