



Box Tree House, Lensbury Avenue, Fulham, SW6

Asking Price: £895,950

 Benham
& Reeves

Box Tree House, Lensbury Avenue, Fulham, SW6

 2 Bedroom (s)  2 Bathroom (s)  Leasehold

A delightfully bright modern flat in Imperial Wharf, one of the finest riverside developments. Set on the second floor, the apartment offers 911 sq. ft. (approx.) of contemporary living space comprising an open plan reception room with floor-to-ceiling windows affording plenty of natural light, and access to a private balcony with a direct river view. There is a fully integrated modern kitchen with high end appliances, dining area and utility room. The main bedroom benefits from built in storage and en-suite bathroom, there is a further double bedroom and an additional family bathroom. The apartment further benefits from air cooling/heating system, an extra storage cupboard in the hallway, wooden flooring throughout and a right to park in the underground car park.

Located on the north bank of the River Thames in SW6 adjacent to Chelsea Harbour, Imperial Wharf is a luxury riverside complex by developers St George with on-site amenities which include a 24-hour concierge, a residents' gym, Tesco, landscaped gardens and a range of cafes and restaurants. A real local community and all the amenities you could wish for, all set within walking distance to the fabulous King's Road, which provides various choices of cuisines, cafes, bars and boutiques.

The Imperial Wharf rail station is 0.1 miles away and provides quick links to Clapham Junction, Shepherds Bush (for the Central line and Westfield shopping centre) and Fulham Broadway (District line).





Property Features:

- Two Bedrooms
- Two Bathrooms
- 2nd Floor
- 911 Square Feet (Approx.)
- Private Balcony with Direct River Views
- Larger Than Average
- 24 Hour Concierge Service
- Residential Gym
- Communal Garden
- Imperial Wharf London Overground Line. (Zone 2)



Box Tree House, Lensbury Avenue, Fulham, SW6

BOX TREE HOUSE, IMPERIAL WHARF

APPROXIMATE GROSS INTERNAL FLOOR AREA 911 SQ.FT (84.6 SQ.M)

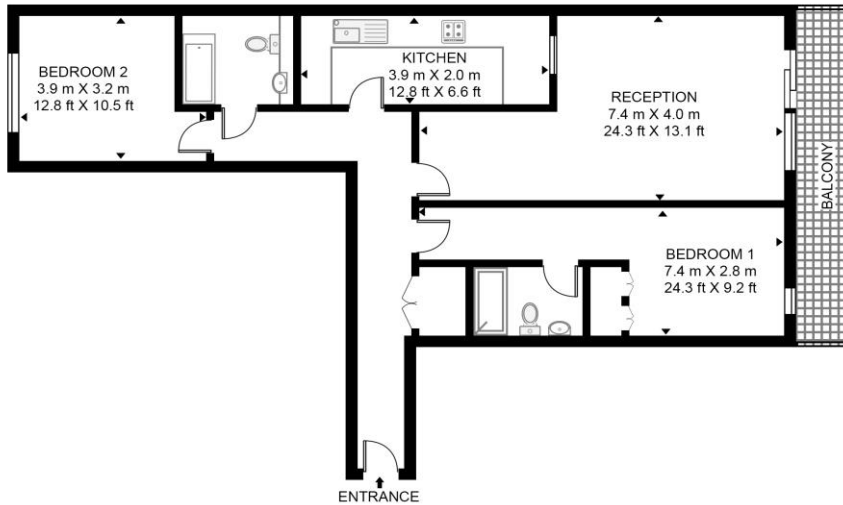

SECOND FLOOR

Energy Efficiency Rating

	Current	Potential
<i>Very energy efficient - lower running costs</i>		
(92+) A		
(81-91) B	85	85
(69-80) C		
(55-68) D		
(39-54) E		
(21-38) F		
(1-20) G		
<i>Not energy efficient - higher running costs</i>		
England, Scotland & Wales	EU Directive 2002/91/EC	

This floor plan has been defined by the RICS Code of Measurement. This floor plan and all others are for approximate representative purposes only and upon usage is agreed to as such by the client.

Terms & Conditions:

These particulars are for guidance purposes only and do not form part of an offer or contract.

Asking Price: £895,950

Tenure: Leasehold
Expires 24/12/2998
Approximately 974 Years Remaining

Ground Rent: £900.00 (per annum)
Review period: 20 years
Next: 2039
Increase: Double

Service Charge: £9,300.00 (per annum) for the year 2024

Anticipated Rent: £3,655.00 pcm
Approx. 4.9 % Yield

Viewings:

All viewings are by appointment only through our Imperial Wharf Office.

Our reference: NIN240105

T: 020 3282 3700

E: imperialwharf.sales@benhams.com

W: www.benhams.com

Disclaimer: These particulars are for guidance purposes only and do not form part of an offer or contract. Whilst care has been taken in their preparation, Benham and Reeves or the vendor shall not be held responsible for any inaccuracies. You should not rely on statements by Benham and Reeves Ltd in the particulars or by word of mouth or in writing as being factually accurate about the property, its condition or its value. Any areas, measurements or distances are approximate. The text, photographs and plans are for guidance only. The photographs appearing in these particulars show only certain parts of the property at the time when the photographs were taken. It should not be assumed that the property has all or any of the necessary planning permission, building regulation consent approval or other required consents for its previous, present or future intended usage. Any intending purchasers must satisfy themselves by inspection or by taking appropriate professional advice. Benham and Reeves Ltd has not rested any of the equipment, fittings or facilities.

London | Canary Wharf | City | Colindale | Dartmouth Park | Ealing | Fulham | Hampstead
Hammersmith | Highgate | Hyde Park | Kensington | Kew | Knightsbridge | Nine Elms
Surrey Quays | Shoreditch | Wembley | Wapping | White City | Woolwich

International | China | Hong Kong | India | Israel | Malaysia | Middle East | Pakistan
Singapore | South Africa | Turkey

