



Grahame Park Way, Colindale, NW9

Asking Price: £450,000

 Benham
& Reeves

Grahame Park Way, Colindale, NW9

 2 Bedroom (s)  2 Bathroom (s)  Leasehold

REF#: BEA250008

A bright and airy two bedroom apartment situated on the second floor and spanning an impressive 884 square feet (approx.). Boasting from a large open planned living room with a stylishly fitted kitchen benefiting from integrated appliances and direct access to a private balcony facing south over the beautifully landscaped gardens. Both carpeted bedrooms face east and offer ample room for wardrobes with the principle bedroom having the added luxury of an ensuite shower room. Further benefits include a three piece family bathroom suite, utility & storage cupboard, secure allocated parking bay, and no onward selling chain.

Trinity Square has everything you might need right on your doorstep – great transport connections, good schools within walking distance, a number of shops, restaurants and bars close by and the countryside within easy reach. All our homes are warm and welcoming. Each apartment will have its own landscaped inner courtyard garden, providing a serene space to relax or entertain.





Property Features:

- Allocated Gated Parking Space
- Chain Free
- Stylish Two Bedroom Apartment
- Two Bathrooms
- 884 Square Feet (Approx.)
- Second Floor
- South Facing Balcony Overlooking Landscaped Gardens Located Near Mill Hill Broadway & Colindale Tube Station

Total Gross Internal Area
82.1 Sq/m - 884 Sq/ft

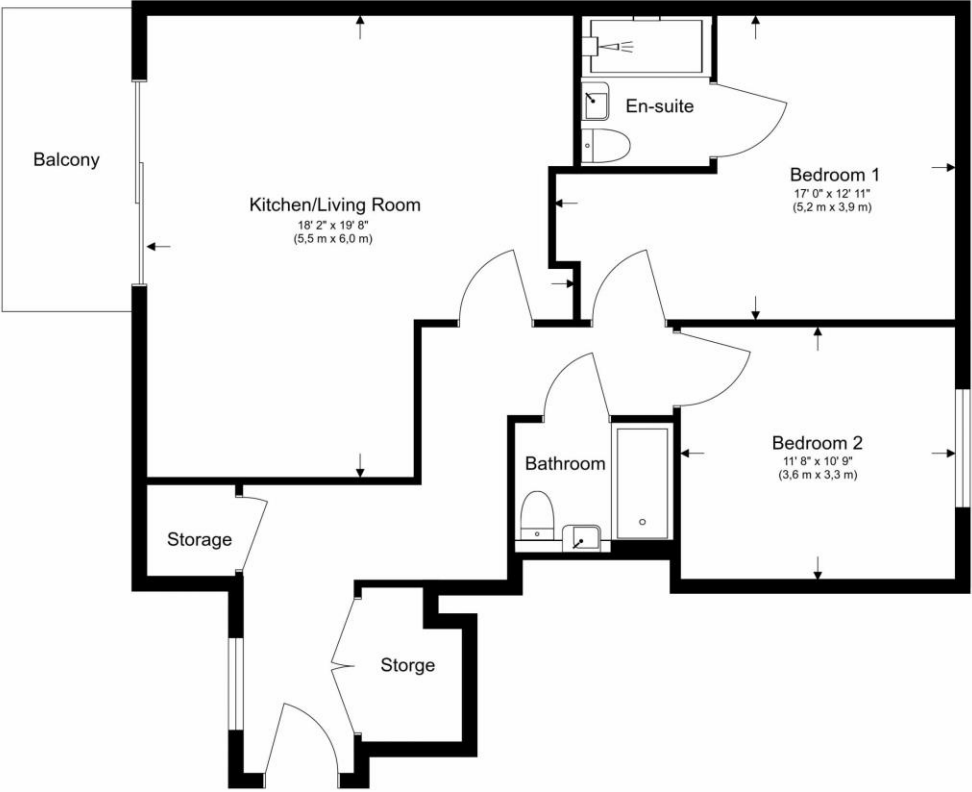

Energy Efficiency Rating		
	Current	Potential
Very energy efficient - lower running costs		
(92+) A		
(81-91) B	91	91
(69-80) C		
(55-68) D		
(39-54) E		
(21-38) F		
(1-20) G		
Not energy efficient - higher running costs		
England, Scotland & Wales	EU Directive 2002/91/EC	

Floor Plan measurements are approximate and are for illustrative purposes only. While we do not doubt the floor plans accuracy, we make no guarantee, warranty or representation as to the accuracy and completeness of the floor plan.

Terms & Conditions:

These particulars are for guidance purposes only and do not form part of an offer or contract.

Asking Price:	£450,000
Tenure:	Leasehold Expires 30/09/3014 Approximately 989 Years Remaining
Ground Rent:	£350.00 (per annum) For the year of 2025
Service Charge:	£2,760.00 approx. (per annum) For the year of 2025
Anticipated Rent:	£1,950.00 pcm Approx. 5.2% Yield

Viewings:

All viewings are by appointment only through our Beaufort Park Office.

Our reference: BEA250008

T: 020 8732 7980

E: beaufortpark.sales@benhams.com

W: www.benhams.com

Disclaimer: These particulars are for guidance purposes only and do not form part of an offer or contract. Whilst care has been taken in their preparation, Benham and Reeves or the vendor shall not be held responsible for any inaccuracies. You should not rely on statements by Benham and Reeves Ltd in the particulars or by word of mouth or in writing as being factually accurate about the property, its condition or its value. Any areas, measurements or distances are approximate. The text, photographs and plans are for guidance only. The photographs appearing in these particulars show only certain parts of the property at the time when the photographs were taken. It should not be assumed that the property has all or any of the necessary planning permission, building regulation consent approval or other required consents for its previous, present or future intended usage. Any intending purchasers must satisfy themselves by inspection or by taking appropriate professional advice. Benham and Reeves Ltd has not rested any of the equipment, fittings or facilities.

London | Canary Wharf | City | Colindale | Dartmouth Park | Ealing | Fulham | Hampstead
Hammersmith | Highgate | Hyde Park | Kensington | Kew | Knightsbridge | Nine Elms
Surrey Quays | Shoreditch | Wembley | Wapping | White City | Woolwich

International | China | Hong Kong | India | Israel | Malaysia | Middle East | Pakistan
Singapore | South Africa | Turkey

