



# Oval Village, Kennington Lane, Vauxhall, SE11

Asking Price: £585,000



# Oval Village, Kennington Lane, Vauxhall, SE11

🏠 1 Bedroom (s) 🚿 1 Bathroom (s) 🔑 Leasehold

Spanning an impressive 431 square feet (approx.) a superb apartment arranged over the 7<sup>th</sup> floor of a brand new development due to complete in Q1 2026, with features to include engineered timber floor finishes, a fully equipped integrated kitchen area, a utility cupboard, fitted wardrobes, a 3-piece bathroom suite and a private balcony. The apartment further benefits from comfort cooling and warm air heating.

Residents' facilities include a 24-hour concierge, gym with separate fitness studio, swimming pool, vitality pool, spa treatment centre, private residents' lounge, boardroom style meeting room, private landscaped garden and communal roof terrace.

Positioned next to the famous Oval Cricket Ground, a short walk from the River Thames and an abundance of trendy shops, bars and restaurants. Only moments from Vauxhall, Oval and Kennington stations (Northern line – Zone 1).

## Property Features:

- Completion Q1 2026
- One Bedroom
- One Bathroom
- Seventh Floor
- 431 Square Feet (Approx.)
- Private Balcony
- Residents' Gym, Swimming Pool, Treatment Rooms, Cinema and Meeting Room
- Kennington Underground Station (Northern Line. Zone 1)



## 7th Floor

Total Gross Internal Area  
40 Sq/m - 431 Sq/ft

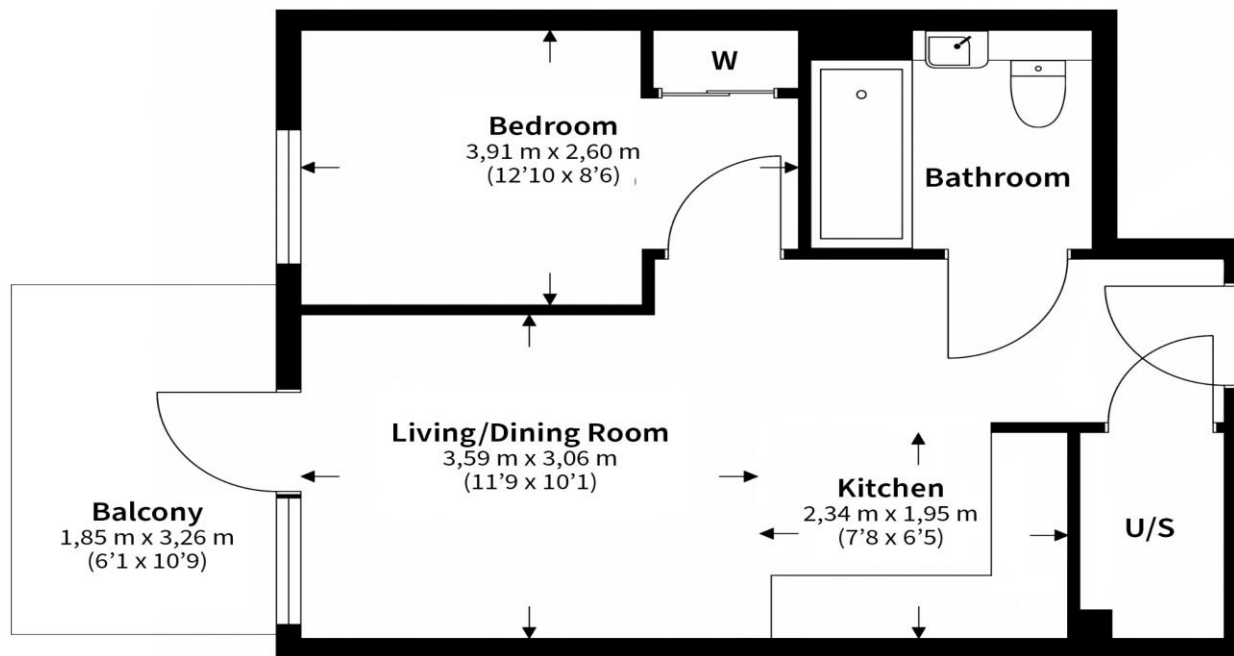

Floor Plan measurements are approximate and are for illustrative purposes only. While we do not doubt the floor plans accuracy, we make no guarantee, warranty or representation as to the accuracy and completeness of the floor plan.

## Terms & Conditions:

These particulars are for guidance purposes only and do not form part of an offer or contract.

Asking Price:	£585,000
Tenure:	Leasehold Expires 01/01/3024 Approximately 999 Years Remaining
Ground Rent:	Peppercorn
Service Charge:	£2,250 pa (estimated) £5.22 per sq.ft to completion

## Viewings:

All viewings are by appointment only through our Nine Elms Office.

Our reference: CHN240008

T: 020 3282 3700

E: [nineelms.sales@benhams.com](mailto:nineelms.sales@benhams.com)

W: [www.benhams.com](http://www.benhams.com)

Disclaimer: These particulars are for guidance purposes only and do not form part of an offer or contract. Whilst care has been taken in their preparation, Benham and Reeves or the vendor shall not be held responsible for any inaccuracies. You should not rely on statements by Benham and Reeves Ltd in the particulars or by word of mouth or in writing as being factually accurate about the property, its condition or its value. Any areas, measurements or distances are approximate. The text, photographs and plans are for guidance only. The photographs appearing in these particulars show only certain parts of the property at the time when the photographs were taken. It should not be assumed that the property has all or any of the necessary planning permission, building regulation consent approval or other required consents for its previous, present or future intended usage. Any intending purchasers must satisfy themselves by inspection or by taking appropriate professional advice. Benham and Reeves Ltd has not rested any of the equipment, fittings or facilities.

London | Canary Wharf | City | Colindale | Dartmouth Park | Ealing | Fulham | Hampstead  
Hammersmith | Highgate | Hyde Park | Kensington | Kew | Knightsbridge | Nine Elms  
Surrey Quays | Shoreditch | Wembley | Wapping | White City | Woolwich

International | China | Hong Kong | India | Israel | Malaysia | Middle East | Pakistan  
Singapore | South Africa | Turkey

