



Crompton Street, Paddington, W2

Asking Price: £650,000

 Benham
& Reeves

Crompton Street, Paddington, W2

 1 Bedroom (s)  1 Bathroom (s)  Leasehold

An impressive one bedroom apartment, spanning 578 square feet of accommodation (approximate) situated in Venice Court. The contemporary interiors feature large, bright and open living space that have been finished to a high specification.

The property comprises a main bedroom suite with a built-in wardrobe, a modern bathroom and a stylish open-plan kitchen/reception room with dining area. The interior features fitted Siemens appliances, integrated wardrobes, wood flooring, air cooling, & two utility/storage cupboards.

Situated at the north end of Edgware Road, living in Venice Court is to enjoy the best of both worlds. A bright, diverse and well-connected central London location combined with a vibrant community spirit and access to a wealth of open, green spaces. Just a short walk from Venice Court lies Little Venice's picturesque Regent's Canal and the affluent residential neighbourhood of Maida Vale. A short stroll, jog or cycle along the Regent's Canal towpath leads you directly into one of London's finest parks. Regent's Park is the largest grass area for sports in Central London and is home to several iconic landmarks including London Zoo, the open-air theatre and a boating lake.





Property Features:

- One Bedroom
- One Bathroom
- 578 Square Feet (Approx.)
- Air Cooling
- Edgware Road Station (0.4 miles)
- Marylebone Station (0.5 miles)
- Paddington Station (0.6 miles)



Ground Floor
Total Gross Internal Area
 53.7 Sq/m - 578 Sq/ft

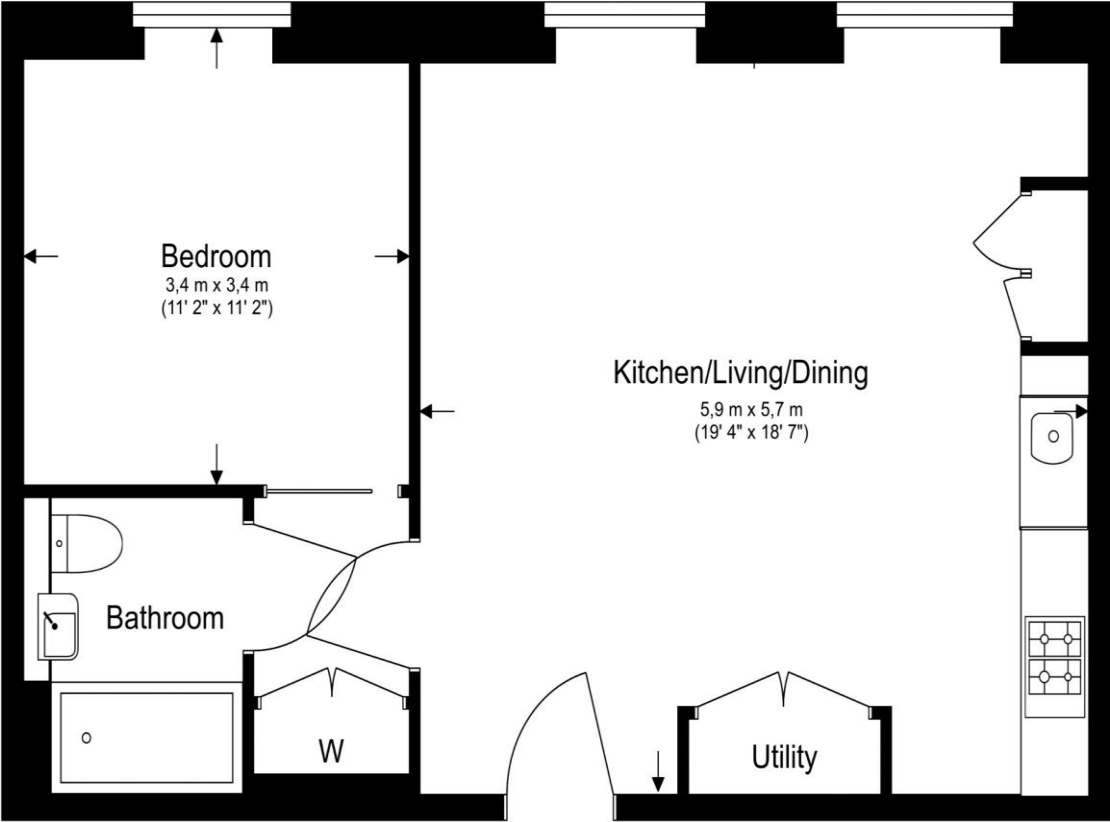

Energy Efficiency Rating		
	Current	Potential
Very energy efficient - lower running costs		
(92+) A		
(81-91) B	82	82
(69-80) C		
(55-68) D		
(39-54) E		
(21-38) F		
(1-20) G		
Not energy efficient - higher running costs		
England, Scotland & Wales	EU Directive 2002/91/EC	

Floor Plan measurements are approximate and are for illustrative purposes only. While we do not doubt the floor plans accuracy, we make no guarantee, warranty or representation as to the accuracy and completeness of the floor plan.

Terms & Conditions:

These particulars are for guidance purposes only and do not form part of an offer or contract.

Asking Price:	£650,000
Tenure:	Leasehold Expires 31/05/2270 Approximately 246 Years Remaining
Ground Rent:	Peppercorn
Service Charge:	£2,384.00 (per annum) for the year 2023
Anticipated Rent:	£2,665.00 pcm Approx. 4.9% Yield

Viewings:

All viewings are by appointment only through our Kensington Office.

Our reference: CHN230021

T: 020 7938 3522

E: kensington.sales@benhams.com

W: www.benhams.com

Disclaimer: These particulars are for guidance purposes only and do not form part of an offer or contract. Whilst care has been taken in their preparation, Benham and Reeves or the vendor shall not be held responsible for any inaccuracies. You should not rely on statements by Benham and Reeves Ltd in the particulars or by word of mouth or in writing as being factually accurate about the property, its condition or its value. Any areas, measurements or distances are approximate. The text, photographs and plans are for guidance only. The photographs appearing in these particulars show only certain parts of the property at the time when the photographs were taken. It should not be assumed that the property has all or any of the necessary planning permission, building regulation consent approval or other required consents for its previous, present or future intended usage. Any intending purchasers must satisfy themselves by inspection or by taking appropriate professional advice. Benham and Reeves Ltd has not rested any of the equipment, fittings or facilities.

London | Canary Wharf | City | Colindale | Dartmouth Park | Ealing | Fulham | Hampstead
Hammersmith | Highgate | Hyde Park | Kensington | Kew | Knightsbridge | Nine Elms
Surrey Quays | Shoreditch | Wembley | Wapping | White City | Woolwich

International | China | Hong Kong | India | Israel | Malaysia | Middle East | Pakistan
Singapore | South Africa | Turkey

